

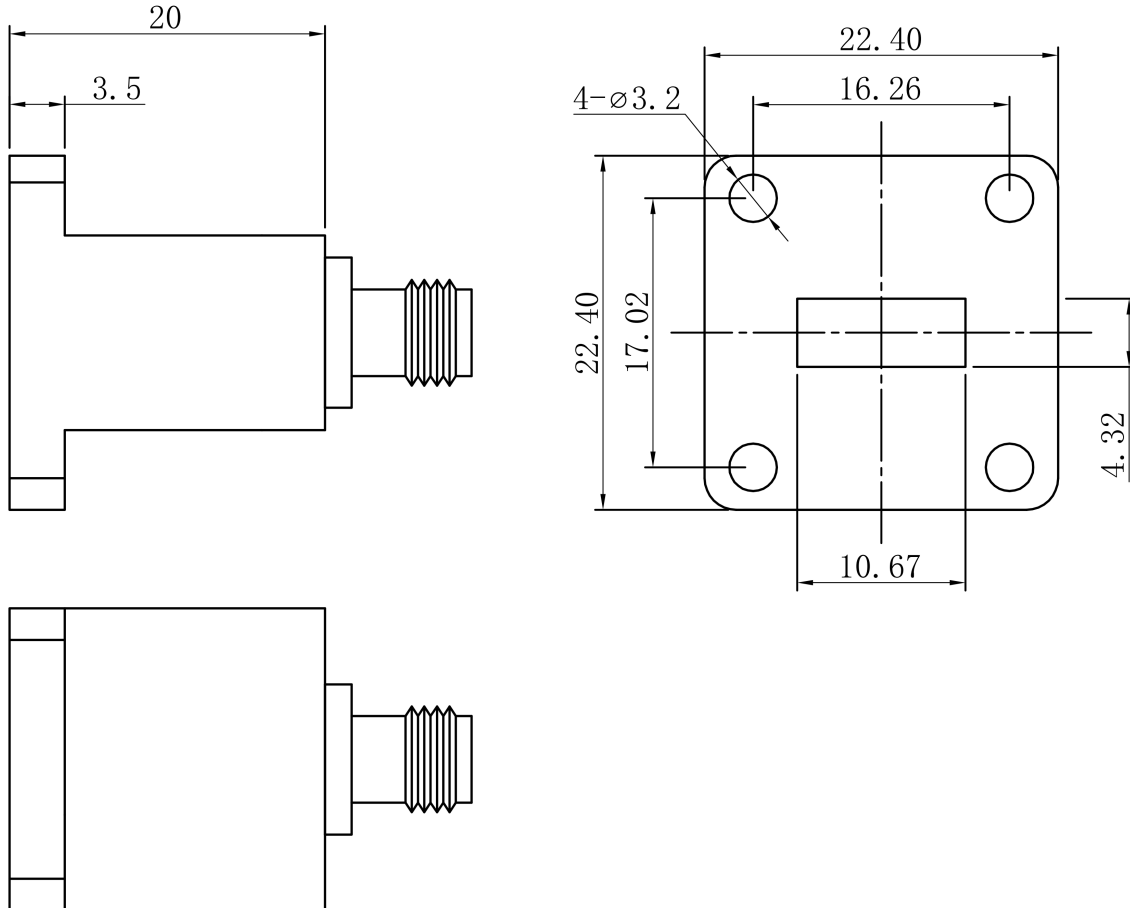

## End Launch Waveguide to Coaxial Adapter, RWR42KE 17.6-26.7GHz, WR42 to 2.92mm Female, UBR220 Flange

### Dimensions(mm) Tolerance $\pm 1\%$



### Electrical & Environmental

Frequency Range	17.6-26.7GHz	Impedance	50 ohm	VSWR	1.2 max
Input Avg Power	10W @25°C	Peak Power	3000W	Insertion Loss	0.35 dB max

### Mechanical & Product Information

Product Number	RWR42KE, H-Grade	Body Geometry	End Launch
Waveguide Body	Copper, grey painted	Waveguide	WR42, UBR220 Flange
Connector Body	Passivated stainless steel	Coax Connector	2.92mm(K,SK) Female
Center Contact	Gold plated beryllium copper		
Operating Temp	-40°C to 70°C	Net Weight	About 40.0g



**End Launch Waveguide to Coaxial Adapter, RWR42KE**  
17.6-26.7GHz, WR42 to 2.92mm(K,SK) Female, UBR220 Flange

**Typical Test Data**

