

## WR90(BJ100) Waveguide Termination, **RWT90500** 8.2-12.4GHz, 500W, FBP100(UBR) Flange, Rectangular

### Dimensions(mm) Tolerance±1%

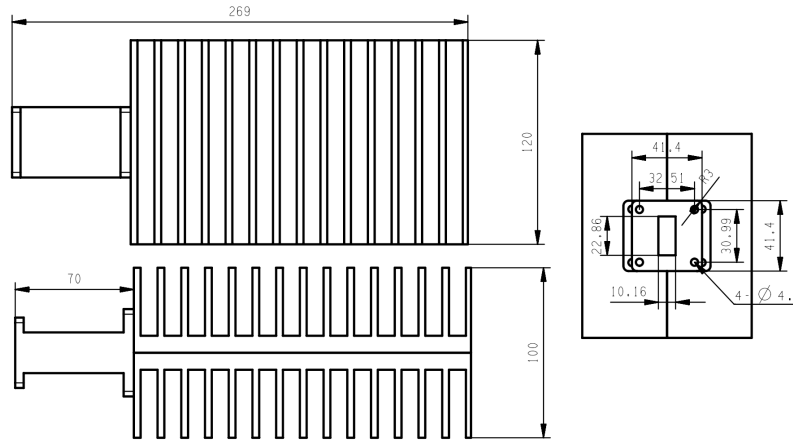

### Electrical & Environmental

Frequency Range	8.2-12.4GHz	Impedance	50 ohm	VSWR	1.15 max
Input Avg Power	500W @25°C	Peak Power	-		

### Mechanical & Product Information

Product Number	RWT90500, P-Grade	Waveguide	WR90(BJ100), FBP100(UBR) Flange
Waveguide Body	Aluminum, black painted	Heat Sink	Black anodized aluminum
Waveguide Cavity	Aluminum, electric conductive oxidation		
Operating Temp	-55°C~+100°C	Net Weight	-

### Typical Test Data

#### Notes

1. Customized outlines and optimal VSWR available.
2. Refer to the derating curve for power input, derate linearly to 50W at 100°C.
3. To maintain best performance, recommended to use fan to keep the case temp under 85°C.

