

## WR510(BJ18) Waveguide Matched Termination, **RWT510** 1.45-2.22GHz, 25W, FDP18(UDR) Flange, Rectangular

### Dimensions(mm) Tolerance±1%

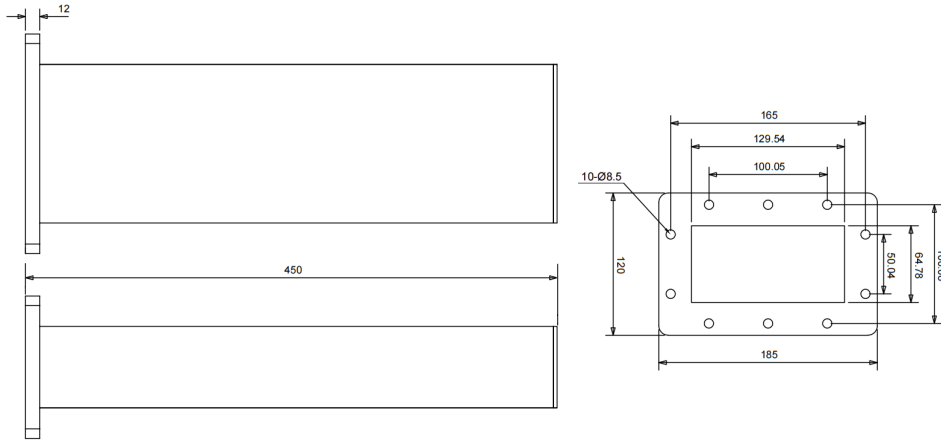

### Electrical & Environmental

<b>Frequency Range</b>	1.45-2.22GHz	<b>Impedance</b>	50 ohm	<b>VSWR</b>	1.03 max
<b>Input Avg Power</b>	25W @25°C	<b>Peak Power</b>	-		

### Mechanical & Product Information

<b>Product Number</b>	RWT510, High-Precision	<b>Waveguide/Flange</b>	WR510(BJ18), FDP18(UDR) Flange
<b>Waveguide Body</b>	Aluminum, grey painted	<b>Heat Sink</b>	N/A
<b>Waveguide Cavity</b>	Aluminum, electric conductive oxidation		
<b>Operating Temp</b>		<b>Net Weight</b>	-

### Typical Test Data

#### Notes

1. Customized outlines and optimal VSWR available.
2. Refer to the derating curve for power input, derate linearly to 3W at 100°C.
3. To maintain best performance, recommended to use fan to keep the case temp under 85°C.

