

WR430(BJ22) Waveguide Matched Termination, **RWT430** 1.72-2.61GHz, 15W, FDP22(UDR) Flange, Rectangular

Dimensions(mm) Tolerance±1%

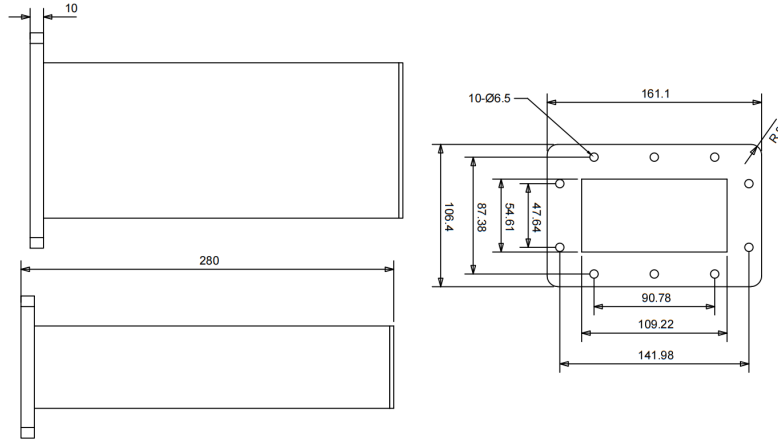

Electrical & Environmental

Frequency Range	1.72-2.61GHz	Impedance	50 ohm	VSWR	1.03 max
Input Avg Power	15W @25°C	Peak Power	-		

Mechanical & Product Information

Product Number	RWT430, High-Precision	Waveguide/Flange	WR430(BJ22), FDP22(UDR) Flange
Waveguide Body	Aluminum, grey painted	Heat Sink	N/A
Waveguide Cavity	Aluminum, electric conductive oxidation		
Operating Temp		Net Weight	-

Typical Test Data

Notes

1. Customized outlines and optimal VSWR available.
2. Refer to the derating curve for power input, derate linearly to 2W at 100°C.
3. To maintain best performance, recommended to use fan to keep the case temp under 85°C.

