

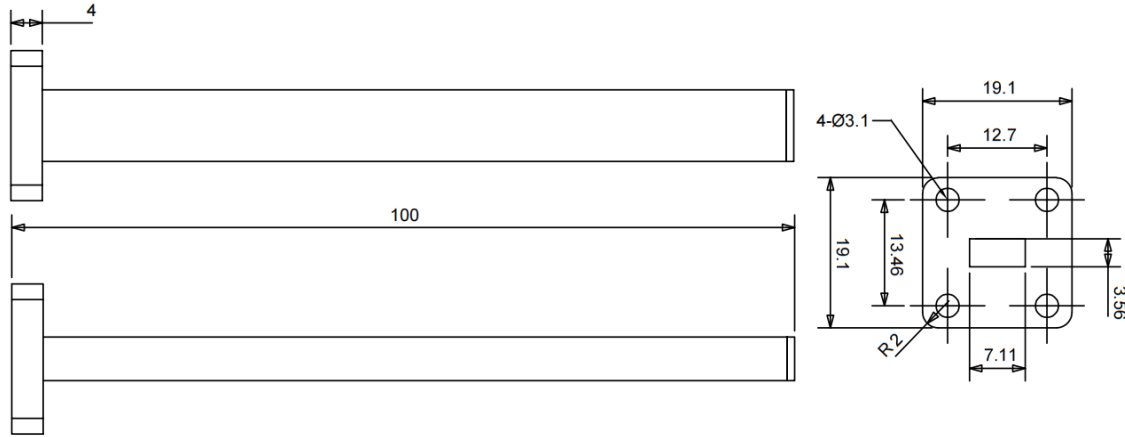

WR28(BJ320) Waveguide Matched Termination, RWT28 26.3-40GHz, 0.5W, FBP320(UBR) Flange, Rectangular

Dimensions(mm) Tolerance±1%



Electrical & Environmental

Frequency Range	26.3-40GHz	Impedance	50 ohm	VSWR	1.03 max
Input Avg Power	0.5W @25°C	Peak Power	-		

Mechanical & Product Information

Product Number	RWT28, High-Precision	Waveguide/Flange	WR28(BJ320), FBP320(UBR) Flange
Waveguide Body	Copper, grey painted	Heat Sink	N/A
Waveguide Cavity	Copper, electric conductive oxidation		
Operating Temp		Net Weight	About 37.0g

Typical Test Data

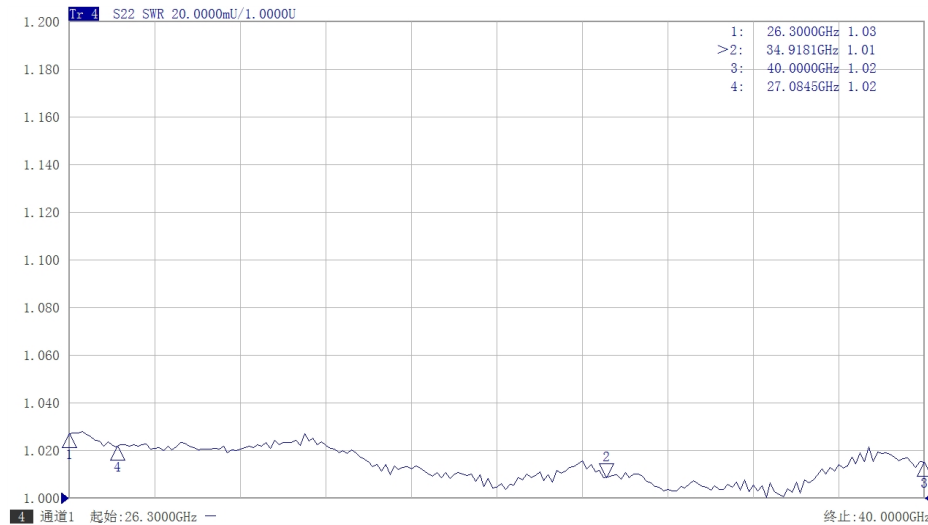

Notes

1. Customized outlines and optimal VSWR available.
2. Refer to the derating curve for power input, derate linearly to 0.1W at 100°C.

