

SSMP(GPPO、SMPM) Male Coaxial Termination, RT401MPM DC-40GHz, 1W, Round

Dimensions(mm) Tolerance $\pm 1\%$

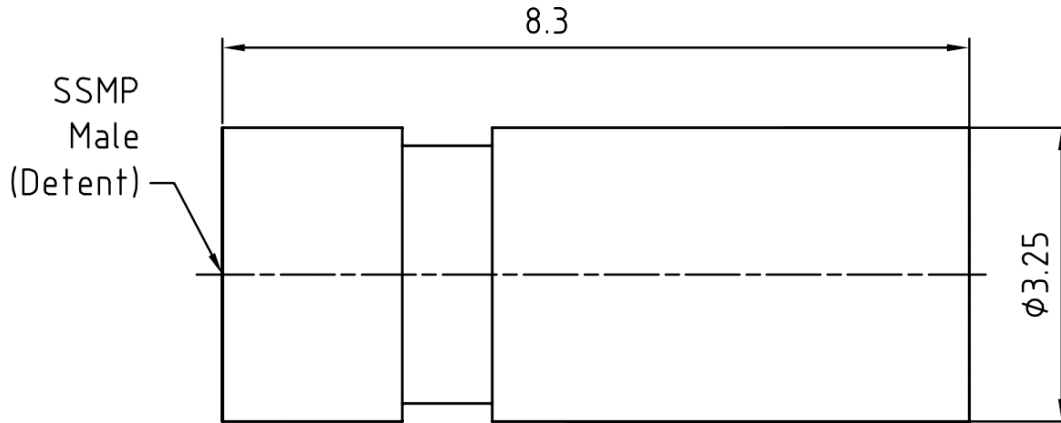

Electrical & Environmental

Frequency Range	DC-40GHz	Impedance	50 ohm	VSWR	1.35 max
Input Avg Power	1W @25°C	Peak Power	50W (5μsec pulse width, 0.4% duty cycle)		

Mechanical & Product Information

Product Number	RT401MPM	Connector	SSMP(GPPO、SMPM) Male
Connector Body	Gold plated beryllium copper	Heat Sink	N/A
Center Contact	Gold plated brass		
Operating Temp		Net Weight	-

Typical Test Data

Notes

1. Customized outlines and optimal VSWR available.
2. Refer to the derating curve for power input, derate linearly to 0.1W at 100°C.

