

## SSMP(GPPO、SMPM) Female Coaxial Termination, RT401MPF DC-40GHz, 1W, Round

Dimensions(mm) Tolerance±1%

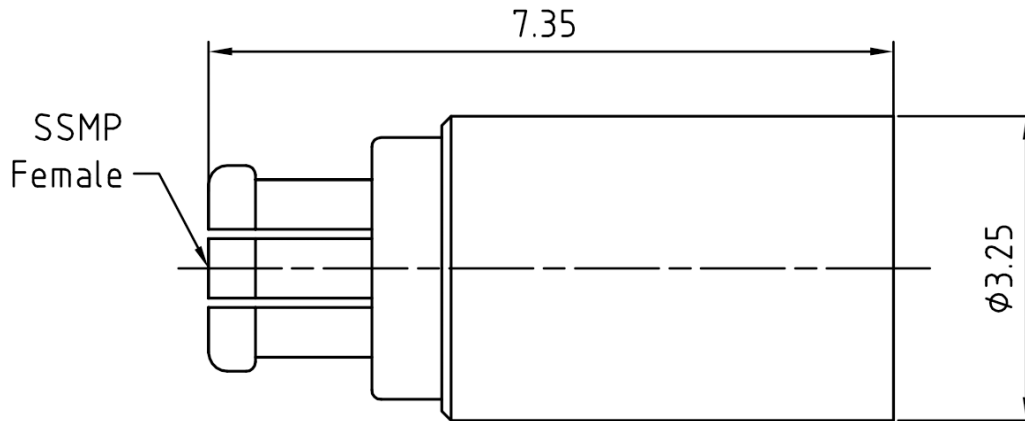

### Electrical & Environmental

<b>Frequency Range</b>	DC-40GHz	<b>Impedance</b>	50 ohm	<b>VSWR</b>	1.4 max
<b>Input Avg Power</b>	1W @25°C	<b>Peak Power</b>	50W (5μsec pulse width, 0.4% duty cycle)		

### Mechanical & Product Information

<b>Product Number</b>	RT401MPF	<b>Connector</b>	SSMP(GPPO、SMPM) Female
<b>Connector Body</b>	Gold plated beryllium copper	<b>Heat Sink</b>	N/A
<b>Center Contact</b>	Gold plated beryllium copper		
<b>Operating Temp</b>		<b>Net Weight</b>	-

### Typical Test Data

#### Notes

1. Customized outlines and optimal VSWR available.
2. Refer to the derating curve for power input, derate linearly to 0.1W at 100°C.

