

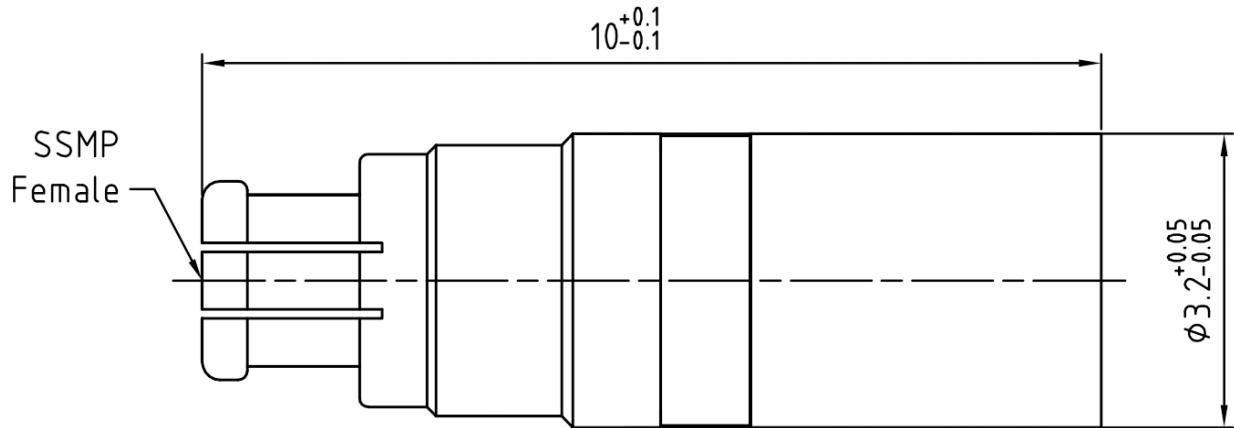

SSMP(GPPO、SMPM) Female Coaxial Termination, RT401MPF-2 DC-40GHz, 1W, Round

Dimensions(mm) Tolerance±1%



Electrical & Environmental

Frequency Range	DC-40GHz	Impedance	50 ohm	VSWR	1.4 max
Input Avg Power	1W @25°C	Peak Power	50W (5μsec pulse width, 0.4% duty cycle)		

Mechanical & Product Information

Product Number	RT401MPF-2	Connector	SSMP(GPPO、SMPM) Female
Connector Body	Gold plated beryllium copper	Heat Sink	N/A
Center Contact	Gold plated beryllium copper		
Operating Temp		Net Weight	About 0.4g

Typical Test Data

Notes

1. Customized outlines and optimal VSWR available.
2. Refer to the derating curve for power input, derate linearly to 0.1W at 100°C.

