

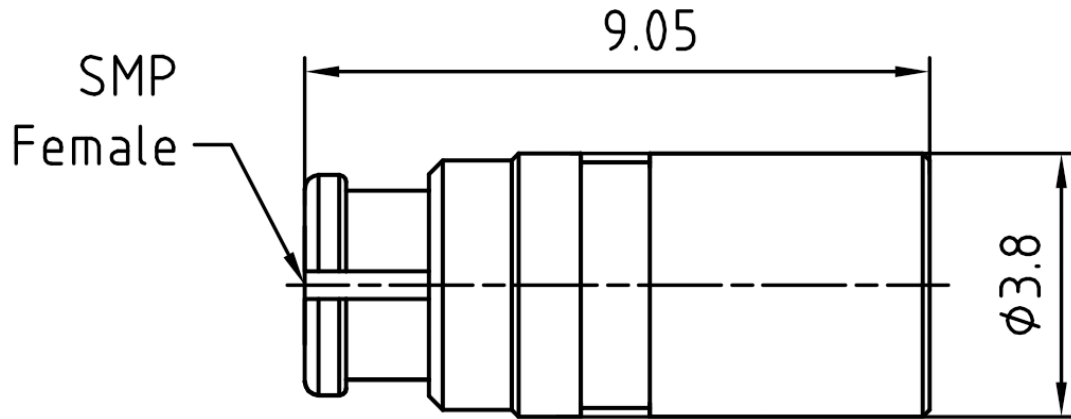

**SMP(GPO) Female Coaxial Termination, RT4005SPF-2**  
DC-40GHz, 0.5W, Round

Dimensions(mm) Tolerance $\pm 1\%$



**Electrical & Environmental**

<b>Frequency Range</b>	DC-40GHz	<b>Impedance</b>	50 ohm	<b>VSWR</b>	1.4 max
<b>Input Avg Power</b>	0.5W @25°C	<b>Peak Power</b>	10W (5μsec pulse width, 0.4% duty cycle)		

**Mechanical & Product Information**

<b>Product Number</b>	RT4005SPF-2	<b>Connector</b>	SMP(GPO) Female
<b>Connector Body</b>	Gold plated beryllium copper	<b>Heat Sink</b>	N/A
<b>Center Contact</b>	Gold plated beryllium copper		
<b>Operating Temp</b>		<b>Net Weight</b>	About 0.4g

**Typical Test Data**

**Notes**

1. Customized outlines and optimal VSWR available.
2. Refer to the derating curve for power input, derate linearly to 0.1W at 100°C.

