

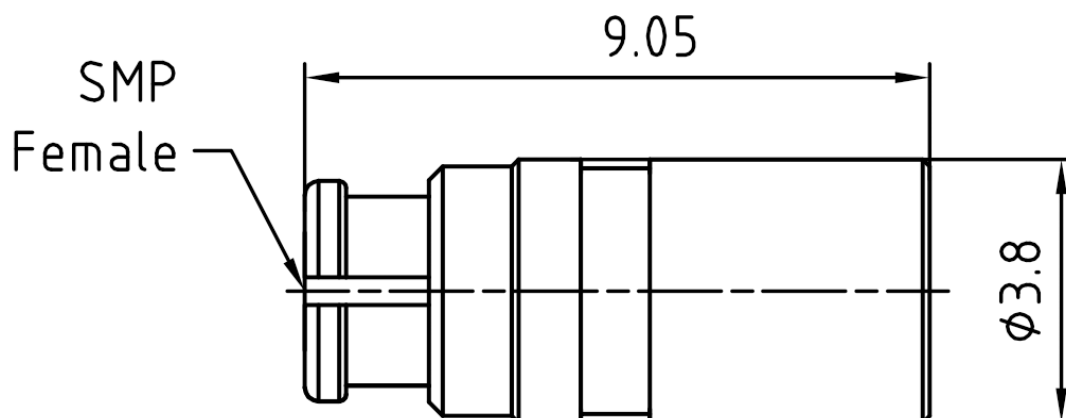

SMP(GPO) Female Coaxial Termination, RT4005PF02 DC-40GHz, 00.5W, Round

Dimensions(mm) Tolerance $\pm 1\%$



Electrical & Environmental

Frequency Range	DC-40GHz	Impedance	50 ohm	VSWR	1.4 max
Input Avg Power	00.5W @25°C	Peak Power	10W (5μsec pulse width, 0.4% duty cycle)		

Mechanical & Product Information

Product Number	RT4005PF02	Connector	SMP(GPO) Female
Connector Body	Gold plated beryllium copper	Heat Sink	N/A
Center Contact	Gold plated beryllium copper		
Operating Temp	-55°C~+125°C	Net Weight	About 0.4g

- 1.Customized connectors, dimensions, PIM, VSWR.
- 2.Refer to the RFTOP Termination selection and usage guide.

Notes: To ensure longevity and performance, do not use at full power for a long time. Peak power, pulse width, and duty cycle need to meet the requirements. Input high power, require heat dissipation, maintain temperature within 60°C. Reference Curve,derate linearly to 0.1W at 100°C.

