

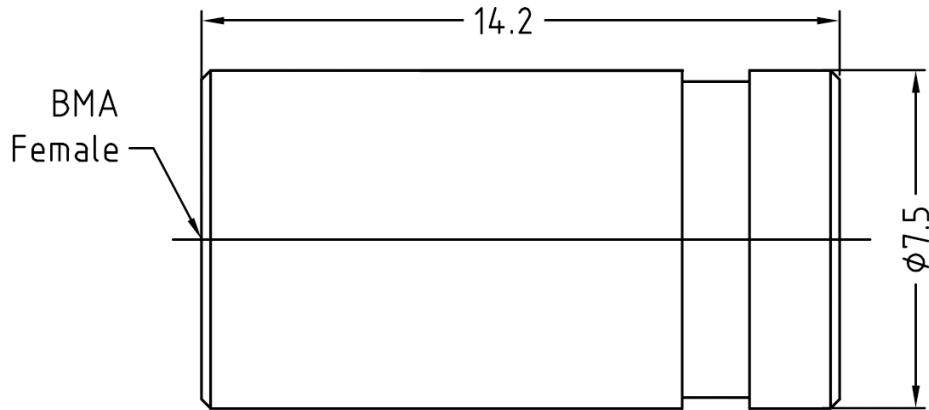

## BMA Female Coaxial Termination, RT272BAF DC-26.5GHz, 2W, Round

### Dimensions(mm) Tolerance $\pm 1\%$



### Electrical & Environmental

Frequency Range	DC-26.5GHz	Impedance	50 ohm	VSWR	1.25 max
Input Avg Power	2W @25°C	Peak Power	100W (5 $\mu$ sec pulse width, 0.4% duty cycle)		

### Mechanical & Product Information

Product Number	RT272BAF	Connector	BMA Female
Connector Body	Passivated stainless steel	Heat Sink	N/A
Center Contact	Gold plated beryllium copper		
Operating Temp	-55°C~+125°C	Net Weight	About 2.1g

### Typical Test Data

#### Notes

1. Customized outlines and optimal VSWR available.
2. Refer to the derating curve for power input, derate linearly to 0.2W at 100°C.

