

1.0mm Female Coaxial Termination, RT1101FH DC-110GHz, 1W, Round

Dimensions(mm) Tolerance±1%

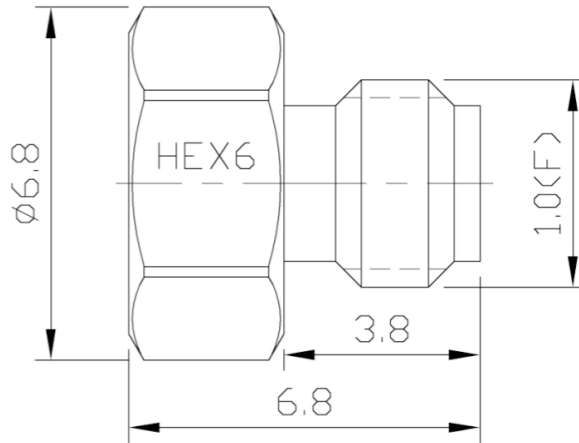

Electrical & Environmental

Frequency Range	DC-110GHz	Impedance	50 ohm	VSWR	1.45 max
Input Avg Power	1W @25°C	Peak Power	10W (5μsec pulse width, 5% duty cycle)		

Mechanical & Product Information

Product Number	RT1101FH, JP-Grade	Connector	1.0mm Female
Connector Body	Passivated stainless steel	Heat Sink	N/A
Center Contact	1.27um gold plated beryllium copper		
Operating Temp	-55°C~+100°C	Net Weight	About 0.8g

Typical Test Data

Notes

1. Customized outlines and optimal VSWR available.
2. Refer to the derating curve for power input, derate linearly to 0.1W at 100°C.

