

WR75(BJ120) Radius Right Angle Bent Waveguide, RWGWH75-L-L 9.84-15GHz, FBP120(UBR) Flange, H-Bend

Dimensions(mm) Tolerance $\pm 1\%$

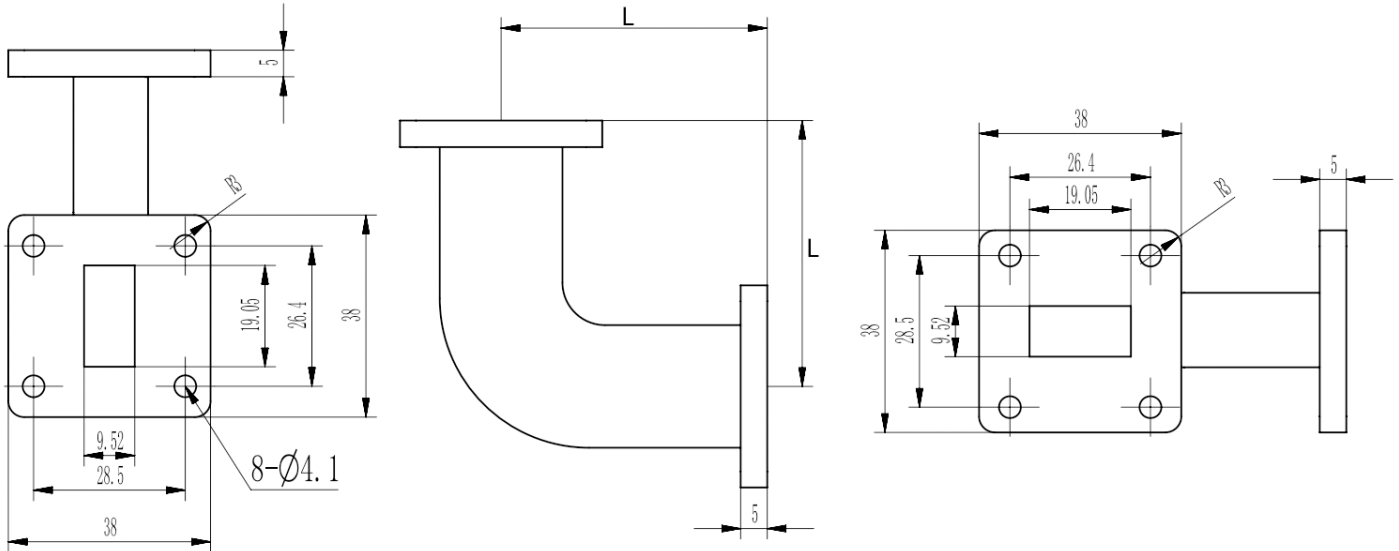

Electrical & Environmental

| | |
|-------------------|---------------|
| Frequency Range | 9.84-15GHz |
| VSWR | 1.15 Max |
| Temperature Range | -40°C to 70°C |

| Product Selection, Customizable | | | |
|---------------------------------|-------|--------|--------|
| RFTOP P/N | L(mm) | L2(mm) | IL(dB) |
| RWGWH75-50-50 | 50 | 50 | 0.10 |

Mechanical & Product Information

| | |
|----------------|---|
| Product Number | RWGWH75-L-L |
| Product Type | Bent Waveguide |
| Waveguide 1 | WR75(BJ120), FBP120(UBR) Flange |
| Waveguide 2 | WR75(BJ120), FBP120(UBR) Flange |
| Waveguide Body | Aluminum, grey painted |
| Center Contact | Aluminum, electric conductive oxidation |

Notes

1. Customized services include: length and structure and flange type.
2. The marked loss is the theoretical estimated loss, for reference only, the specific product after processing test shall prevail.
3. Please refer to the second page of the specification of typical electrical performance measured curve.

WR75(BJ120) Radius Right Angle Bent Waveguide, RWGWH75-L-L
9.84-15GHz, FBP120(UBR) Flange, H-Bend

Typical Test Data

