

## WR112(R84) Radius Right Angle Bent Waveguide, RWGWE112G-L1-L2 6.57-9.99GHz, PDR84 Flange, E-Bend

Dimensions(mm) Tolerance $\pm 1\%$

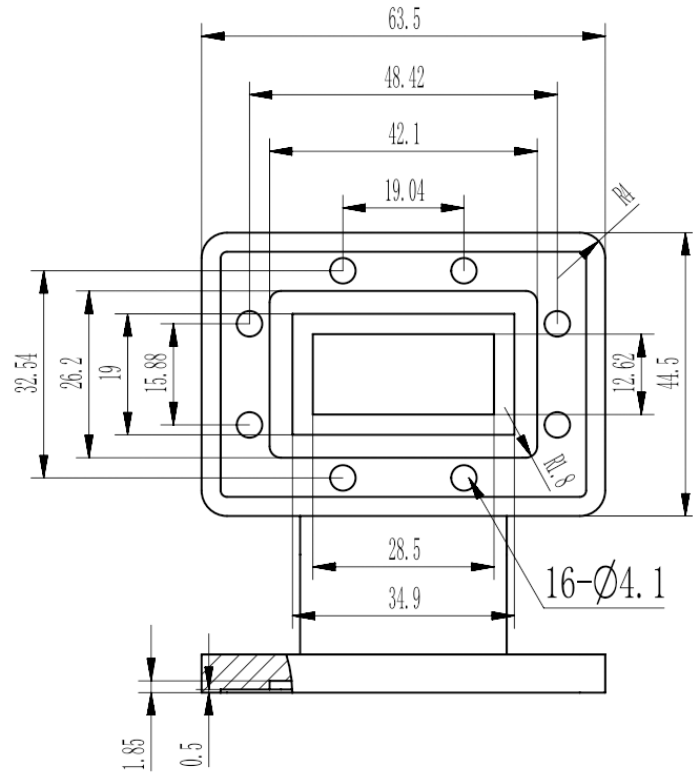
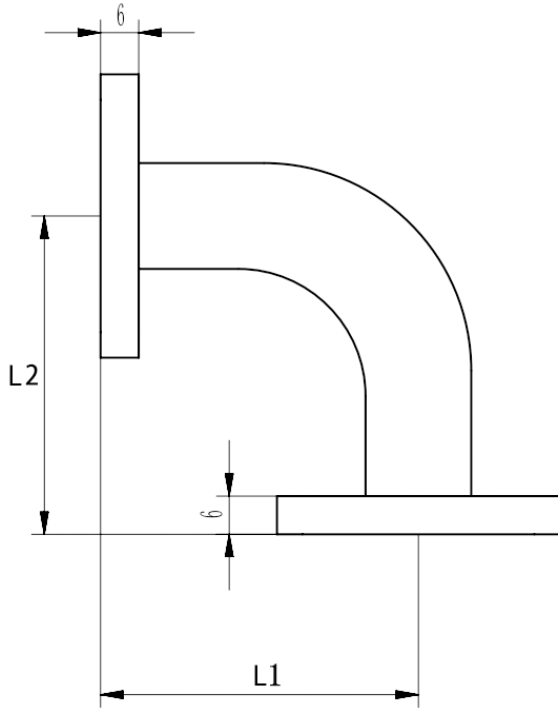

### Electrical & Environmental

Frequency Range	6.57-9.99GHz
VSWR	1.1 Max
Temperature Range	-40°C~+70°C

### Product Selection, Customizable

RFTOP P/N	L1(mm)	L2(mm)	IL(dB)
-----------	--------	--------	--------

### Mechanical & Product Information

Product Number	RWGWE112G-L1-L2
Product Type	Bent Waveguide
Waveguide 1	WR112(R84), PDR84 Flange
Waveguide 2	WR112(R84), UDR84 Flange
Waveguide Body	Aluminum, grey painted
Center Contact	Aluminum, electric conductive oxidation

### Notes

1. Customized services include: length and structure and flange type.
2. The marked loss is the theoretical estimated loss, for reference only, the specific product after processing test shall prevail.
3. Please refer to the second page of the specification of typical electrical performance measured curve.