

WR5(R1800) 1/4 Line, RWGQL5
145-220GHz, FUGP1800 Flange

Dimensions(mm) Tolerance $\pm 1\%$

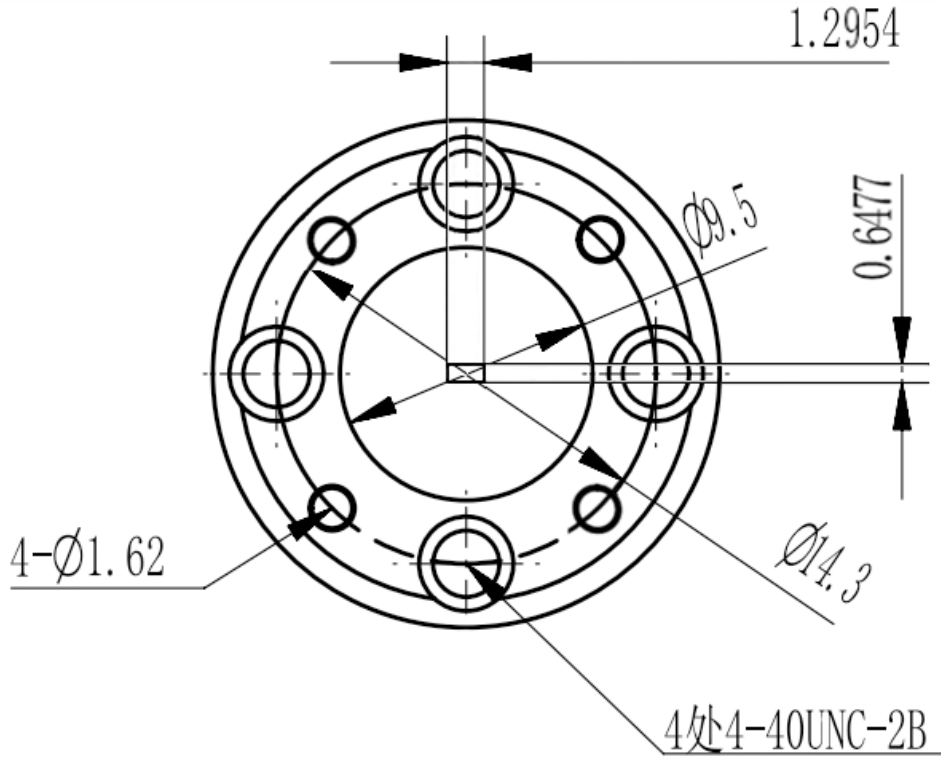

Electrical & Environmental

Frequency Range	145-220GHz
Temperature Range	-40°C~+70°C

Mechanical & Product Information

Product Number	RWGQL5
Product Type	1/4 Line
Waveguide 1	WR5(R1800), FUGP1800 Flange
Waveguide 2	WR5(R1800), FUGP1800 Flange
Waveguide Body	Copper, gold plated
Center Contact	Copper, gold plated