

WR42(BJ220) 1/4 Line, **RWGQL42**
17.6-26.7GHz, FBP220(UBR) Flange

Dimensions(mm) Tolerance $\pm 1\%$

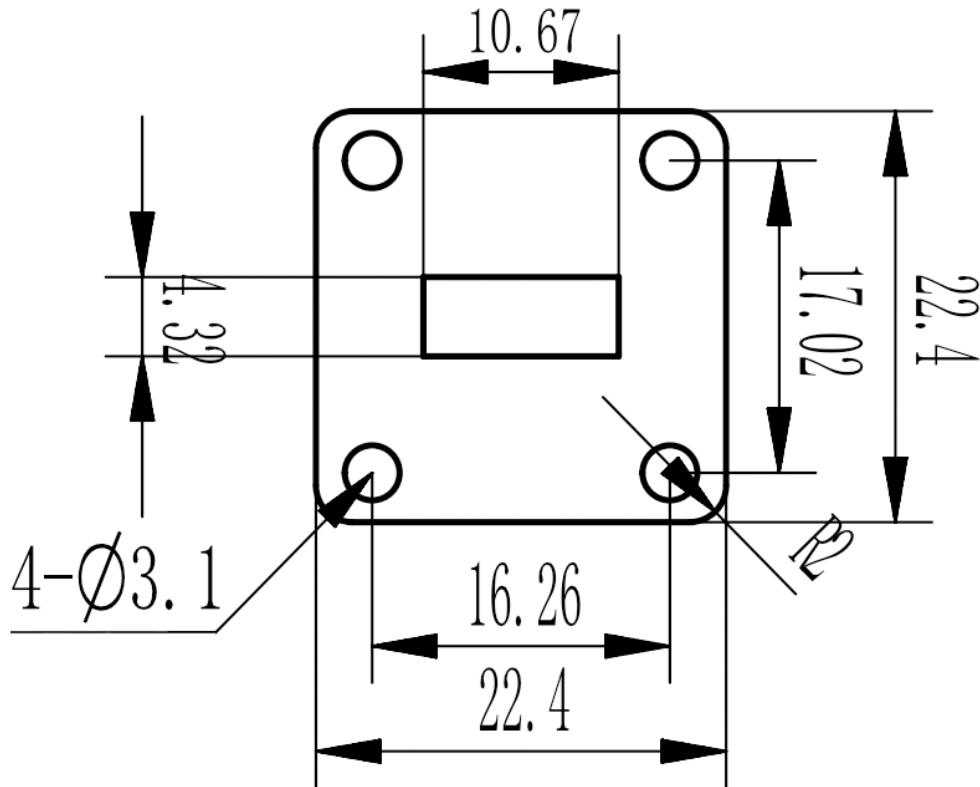

Electrical & Environmental

Frequency Range	17.6-26.7GHz
Temperature Range	-40°C to 70°C

Mechanical & Product Information

Product Number	RWGQL42
Product Type	1/4 Line
Waveguide 1	WR42(BJ220), FBP220(UBR) Flange
Waveguide 2	WR42(BJ220), FBP220(UBR) Flange
Waveguide Body	Copper, grey painted
Center Contact	Copper pickling