

WR430(R22) Waveguide Pressure Windows, RWGPW430G-L 1.72-2.61GHz, PDR22 Flange/UDR22 Flange

Dimensions(mm) Tolerance $\pm 1\%$

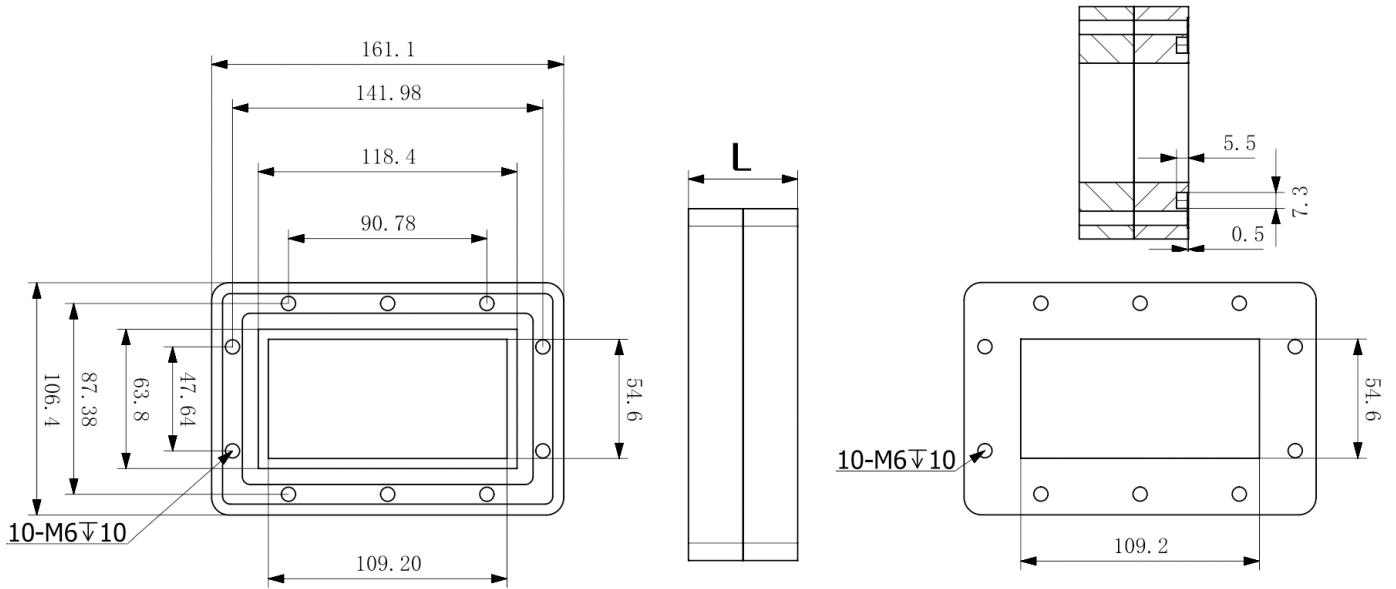

Electrical & Environmental

Frequency Range	1.72-2.61GHz
VSWR	<1.2 Max
Insertion Loss	<0.3dB Max
Temperature Range	-40°C~+70°C

Product Selection, Customizable		
RFTOP P/N	L(mm)	IL(dB)
RWGPW430G-50	50	≤ 0.30

Mechanical & Product Information

Product Number	RWGPW430G-L
Product Type	Waveguide Pressure Windows
Waveguide 1	WR430(R22), PDR22 Flange
Waveguide 2	WR430(R22), UDR22 Flange
Waveguide Body	Aluminum, grey painted
Center Contact	Aluminum, electric conductive oxidation

Notes

1. Customized services include: length and structure and flange type.
2. The marked loss is the theoretical estimated loss, for reference only, the specific product after processing test shall prevail.
3. Please refer to the second page of the specification of typical electrical performance measured curve.