

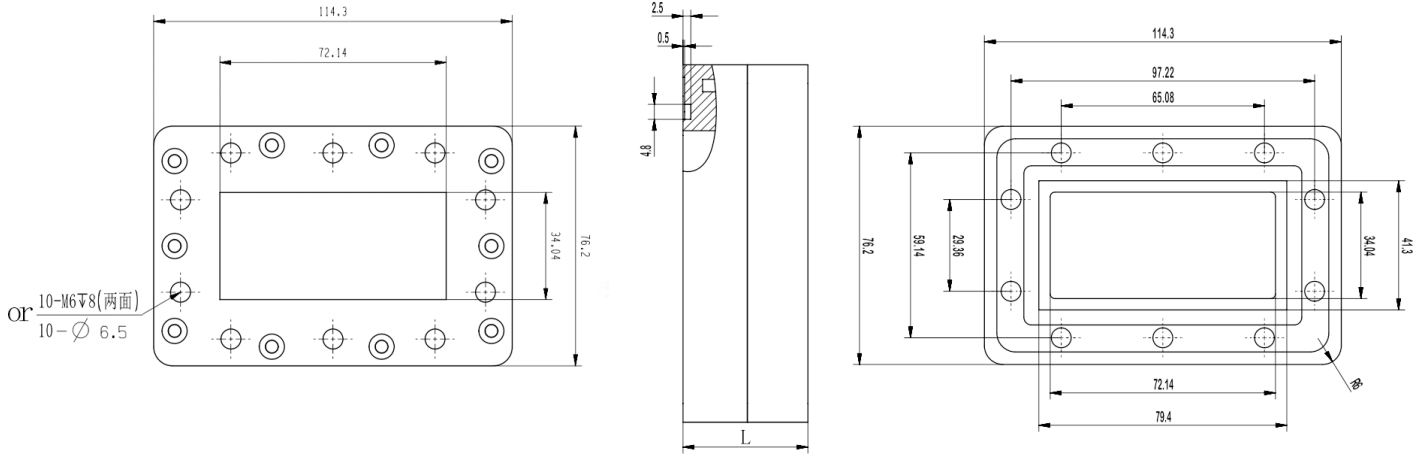

## WR284(R32) Waveguide Pressure Windows, RWGPW284G-L 2.6-3.95GHz, 1500W, PDR32 Flange/UDR32 Flange

### Dimensions(mm) Tolerance±1%



### Electrical & Environmental

Frequency Range	2.6-3.95GHz
VSWR	1.2 Max
Insertion Loss	0.3dB Max
Input Avg Power	1500W @25°C
Operating Pressure	100000psig Max
Temperature Range	-40°C~+70°C

Product Selection, Customizable			
RFTOP P/N	Spec	L(mm)	IL(dB)
RWGPW284G-19	Hole	19	≤0.30
RWGPW284GT-40	Thread	40	≤0.30
RWGPW284GH-40	Hole	40	≤0.30

### Mechanical & Product Information

Product Number	RWGPW284G-L
Product Type	Waveguide Pressure Windows
Waveguide 1	WR284(R32), PDR32 Flange
Waveguide 2	WR284(R32), UDR32 Flange
Waveguide Body	Aluminum, grey painted
Center Contact	Aluminum, electric conductive oxidation
Dimensions	114.3(L)*76.2(W)*40(H)mm
Net Weight	About 608.0g

#### Notes

1. Customized services include: length and structure and flange type.
2. The marked loss is the theoretical estimated loss, for reference only, the specific product after processing test shall prevail.
3. Please refer to the second page of the specification of typical electrical performance measured curve.



**WR284(R32) Waveguide Pressure Windows, RWGPW284G-L**  
**2.6-3.95GHz, 1500W, FDM32/FDP32 Flange**

**Typical Test Data**

