

WR137(R70) Right Angle Waveguide Rotary Joint, RWGJL137-L1-L2 5.38-8.17GHz, UDR70 Flange

Dimensions(mm) Tolerance $\pm 1\%$

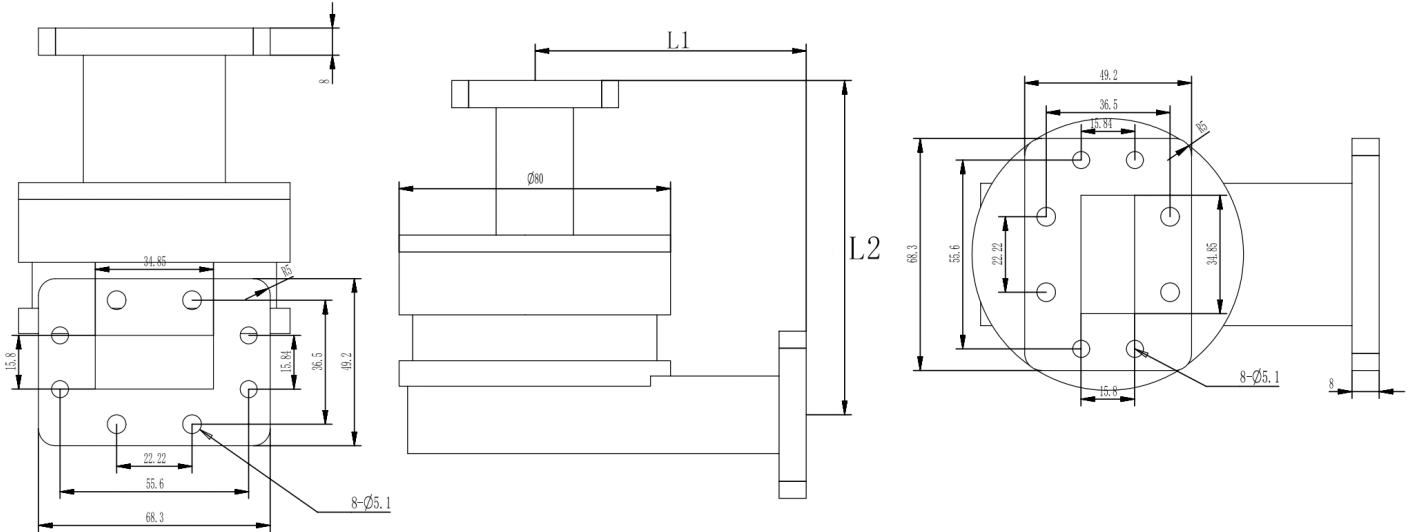

Electrical & Environmental

Frequency Range	5.38-8.17GHz
VSWR	1.2 Max
Temperature Range	-40°C~+70°C

Product Selection, Customizable			
RFTOP P/N	L1(mm)	L2(mm)	IL(dB)
RWGJL137-80-98	79.9	98.4	≤ 0.30

Mechanical & Product Information

Product Number	RWGJL137-L1-L2
Product Type	Waveguide Rotary Joint
Waveguide 1	WR137(R70), UDR70 Flange
Waveguide 2	WR137(R70), UDR70 Flange
Waveguide Body	Aluminum, grey painted
Center Contact	Aluminum, electric conductive oxidation

Notes

1. Customized services include: length and structure and flange type.
2. The marked loss is the theoretical estimated loss, for reference only, the specific product after processing test shall prevail.
3. Please refer to the second page of the specification of typical electrical performance measured curve.

WR137(R70) Right Angle Waveguide Rotary Joint, **RWGJL137-L1-L2** 5.38-8.17GHz, UDR70 Flange

Typical Test Data

79.9 × 98.4mm
□