

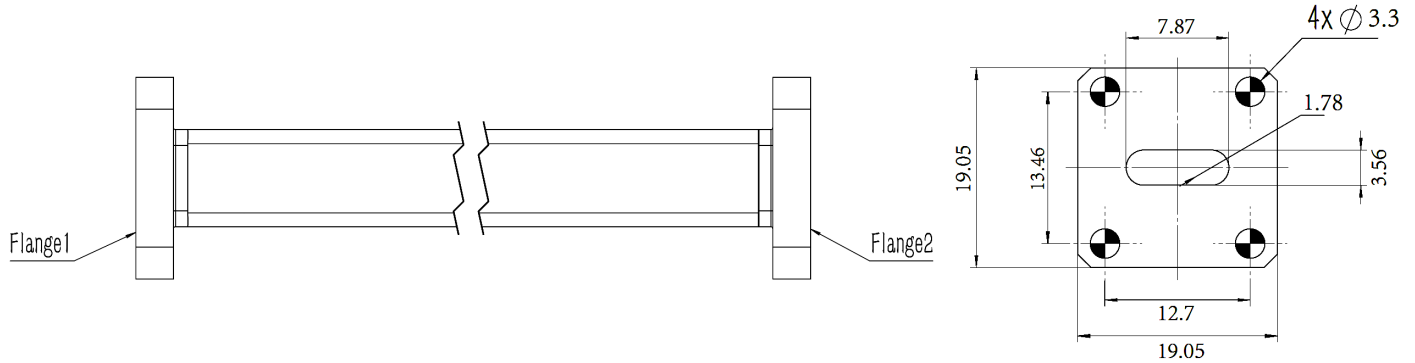

WR28(R320) Flexible Waveguide, RWGFT28-L 26.3-40GHz, 75W, UBR320 Flange, Twistable

Dimensions(mm) Tolerance $\pm 1\%$



Electrical & Environmental

Frequency Range	26.3-40GHz
VSWR	1.3 Max
Input Avg Power	75W @25°C
Min Bend Radius	38mm/E 76mm/H
Repeated Bend Radius	120mm/E 240mm/H
Max. Torsion Angle	510°/m
Operating Pressure	45psig Max
Temperature Range	-40°C~+75°C

Product Selection, Customizable		
RFTOP P/N	L(mm)	IL(dB)
RWGFT28-300	300	≤ 0.98
RWGFT28-1M	1000	≤ 3.28

Notes

1. Customized services include: length and structure and flange type.
2. The marked loss is the theoretical estimated loss, for reference only, the specific product after processing test shall prevail.
3. Please refer to the second page of the specification of typical electrical performance measured curve.

Mechanical & Product Information

Product Number	RWGFT28-L
Product Type	Flexible Waveguide
Waveguide 1	WR28(R320), UBR320 Flange
Waveguide 2	WR28(R320), UBR320 Flange
Waveguide Body	Brass
Center Contact	Brass, silver plating



WR28(R320) Flexible Waveguide, RWGFT28-L
26.3-40GHz, 75W, UBR320 Flange, Twistable

Typical Test Data

300mm

