

WR650(R14) Straight Waveguide, RWG650-L 1.13-1.73GHz, UDR14 Flange

Dimensions(mm) Tolerance $\pm 1\%$

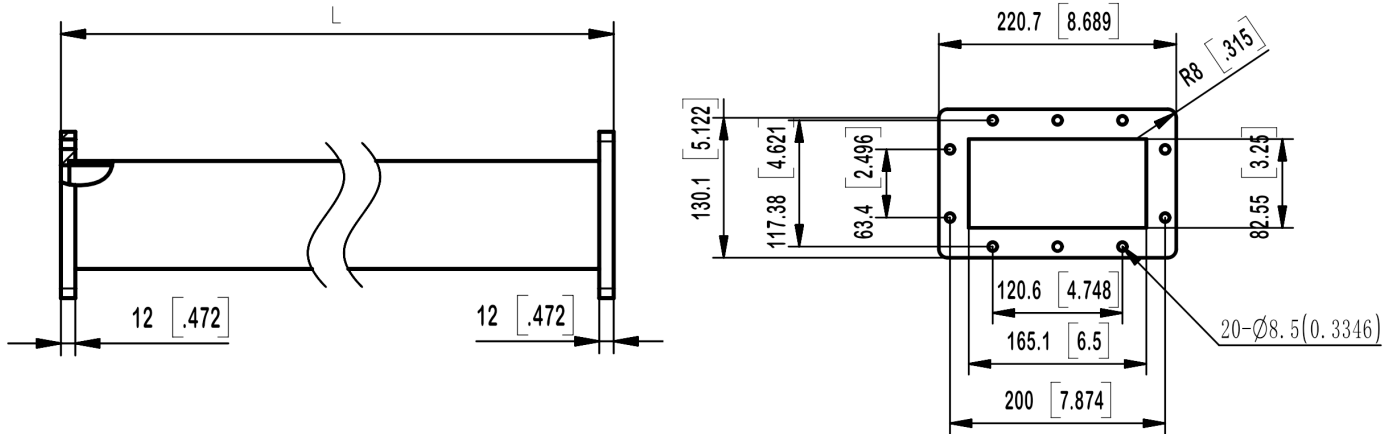

Electrical & Environmental

Frequency Range	1.13-1.73GHz
VSWR	1.1 Max
Temperature Range	-40°C~+70°C

Mechanical & Product Information

Product Number	RWG650-L
Product Type	Straight Waveguide
Waveguide 1	WR650(R14), UDR14 Flange
Waveguide 2	WR650(R14), UDR14 Flange
Waveguide Body	Aluminum, grey painted
Center Contact	Aluminum, electric conductive oxidation

Product Selection, Customizable

RFTOP P/N	L(mm)	IL(dB)
RWG650-100	100	≤0.01
RWG650-300	300	≤0.02
RWG650-500	500	≤0.03
RWG650-1M	1000	≤0.05

Notes

1. Customized services include: length and structure and flange type.
2. The marked loss is the theoretical estimated loss, for reference only, the specific product after processing test shall prevail.
3. Please refer to the second page of the specification of typical electrical performance measured curve.