

## WR5(BJ1800) Straight Waveguide, RWG5-L 145-220GHz, FUGP1800 Circular Flange

### Dimensions(mm) Tolerance $\pm 1\%$

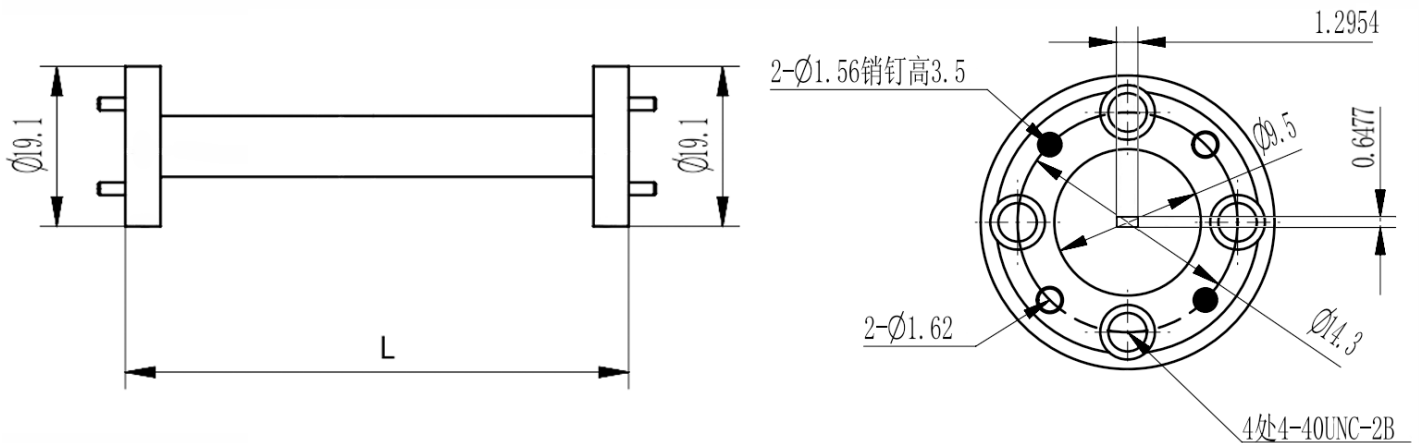

### Electrical & Environmental

Frequency Range	145-220GHz
Temperature Range	-40°C to 70°C

### Product Selection, Customizable

RFTOP P/N	L(mm)	L2(mm)	IL(dB)
-----------	-------	--------	--------

### Mechanical & Product Information

Product Number	RWG5-L
Product Type	Straight Waveguide
Waveguide 1	WR5(BJ1800), FUGP1800 Circular Flange
Waveguide 2	WR5(BJ1800), FUGP1800 Circular Flange
Waveguide Body	Copper, gold plated
Center Contact	Copper, gold plated

### Notes

1. Customized services include: length and structure and flange type.
2. The marked loss is the theoretical estimated loss, for reference only, the specific product after processing test shall prevail.
3. Please refer to the second page of the specification of typical electrical performance measured curve.