

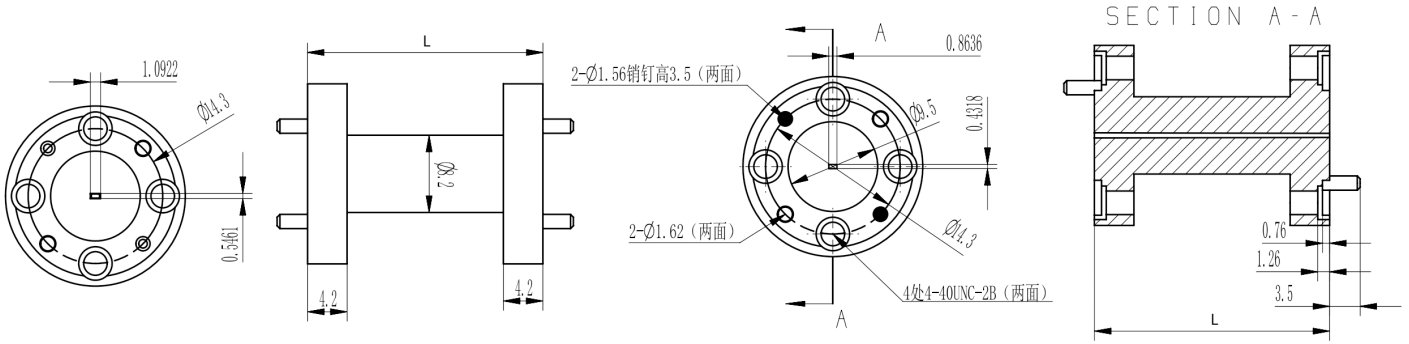

## WR3(BJ2600) to WR4(BJ2200) Transitional Waveguide, RWG3T4-L 217-260GHz, FUGP2600/FUGP2200 Flange

### Dimensions(mm) Tolerance±1%



### Electrical & Environmental

Frequency Range	217-260GHz
VSWR	1.15 Max
Temperature Range	-40°C to 70°C

Product Selection, Customizable		
RFTOP P/N	L(mm)	IL(dB)
RWG3T4-25	25	0.80

### Mechanical & Product Information

Product Number	RWG3T4-L
Product Type	Transitional Waveguide
Waveguide 1	WR3(BJ2600), FUGP2600 Circular Flange
Waveguide 2	WR4(BJ2200), FUGP2200 Circular Flange
Waveguide Body	Copper, gold plated
Center Contact	Copper, gold plated

#### Notes

1. Customized services include: length and structure and flange type.
2. The marked loss is the theoretical estimated loss, for reference only, the specific product after processing test shall prevail.
3. Please refer to the second page of the specification of typical electrical performance measured curve.



## WR3(BJ2600) to WR4(BJ2200) Transitional Waveguide, RWG3T4-L 217-260GHz, FUGP2600/FUGP2200 Flange

### Typical Test Data

