

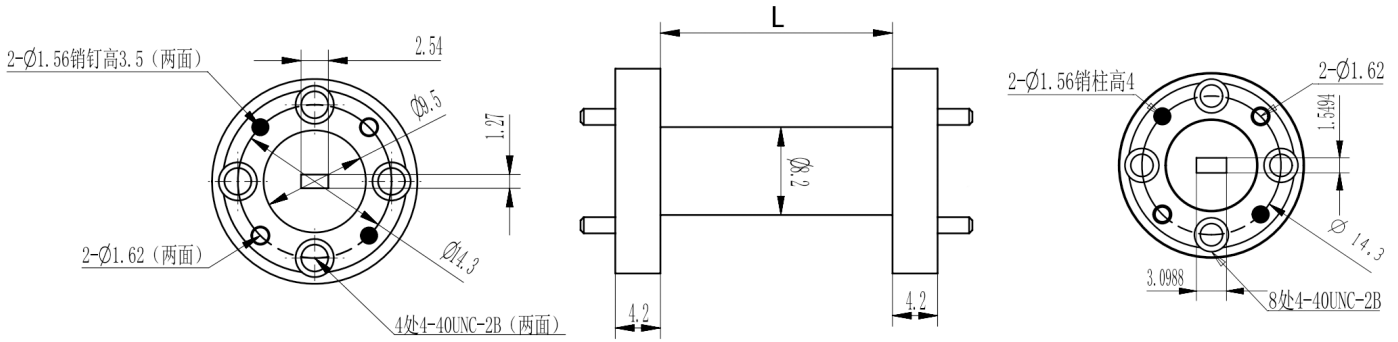

WR10(R900) to WR12(R740) Transitional Waveguide, RWG10T12-L 73.8-91.9GHz, FUGP900 Flange

Dimensions(mm) Tolerance $\pm 1\%$



Electrical & Environmental

Frequency Range	73.8-91.9GHz
VSWR	1.1 Max
Temperature Range	-40°C~+70°C

Product Selection, Customizable

RFTOP P/N	L(mm)	IL(dB)
RWG10T12-30	30	0.29
RWG10T12-50	50	0.46
RWG10T12-100	100	0.87

Mechanical & Product Information

Product Number	RWG10T12-L
Product Type	Transitional Waveguide
Waveguide 1	WR10(R900), FUGP900 Flange
Waveguide 2	WR12(R740), FUGP740 Flange
Waveguide Body	Copper, gold plated
Center Contact	Copper, gold plated

Notes

1. Customized services include: length and structure and flange type.
2. The marked loss is the theoretical estimated loss, for reference only, the specific product after processing test shall prevail.
3. Please refer to the second page of the specification of typical electrical performance measured curve.