

## WRD200 Straight Waveguide, RWDG200-L 2-6GHz, FPWRD200 Flange

### Dimensions(mm) Tolerance $\pm 1\%$

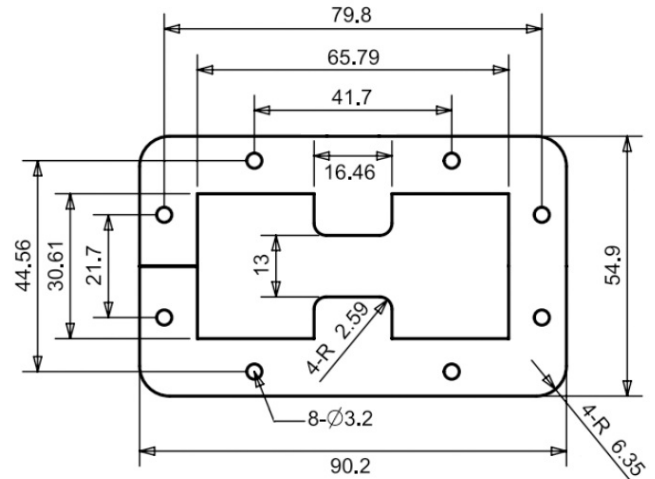
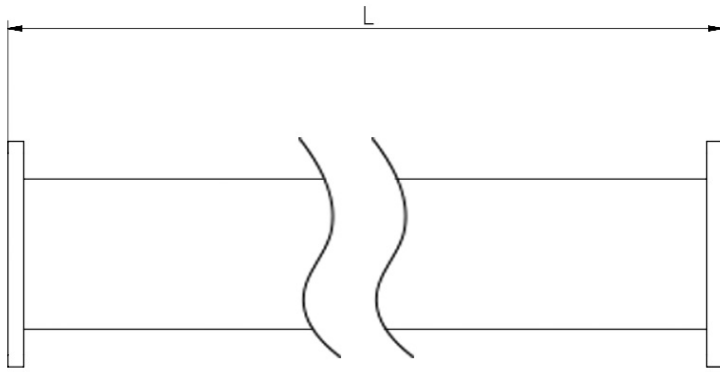

### Electrical & Environmental

Frequency Range	2-6GHz
Temperature Range	-40°C~+70°C

### Product Selection, Customizable

RFTOP P/N	L(mm)	L2(mm)	IL(dB)
-----------	-------	--------	--------

### Mechanical & Product Information

Product Number	RWDG200-L
Product Type	Straight Waveguide
Waveguide 1	WRD200, FPWRD200 Flange
Waveguide 2	WRD200, FPWRD200 Flange
Waveguide Body	Aluminum, grey painted
Center Contact	Aluminum, electric conductive oxidation

### Notes

1. Customized services include: length and structure and flange type.
2. The marked loss is the theoretical estimated loss, for reference only, the specific product after processing test shall prevail.
3. Please refer to the second page of the specification of typical electrical performance measured curve.