

WRD110 Straight Waveguide, RWDG110-L 11-26.5GHz, FPWRD110 Rectangular Flange

Dimensions(mm) Tolerance $\pm 1\%$

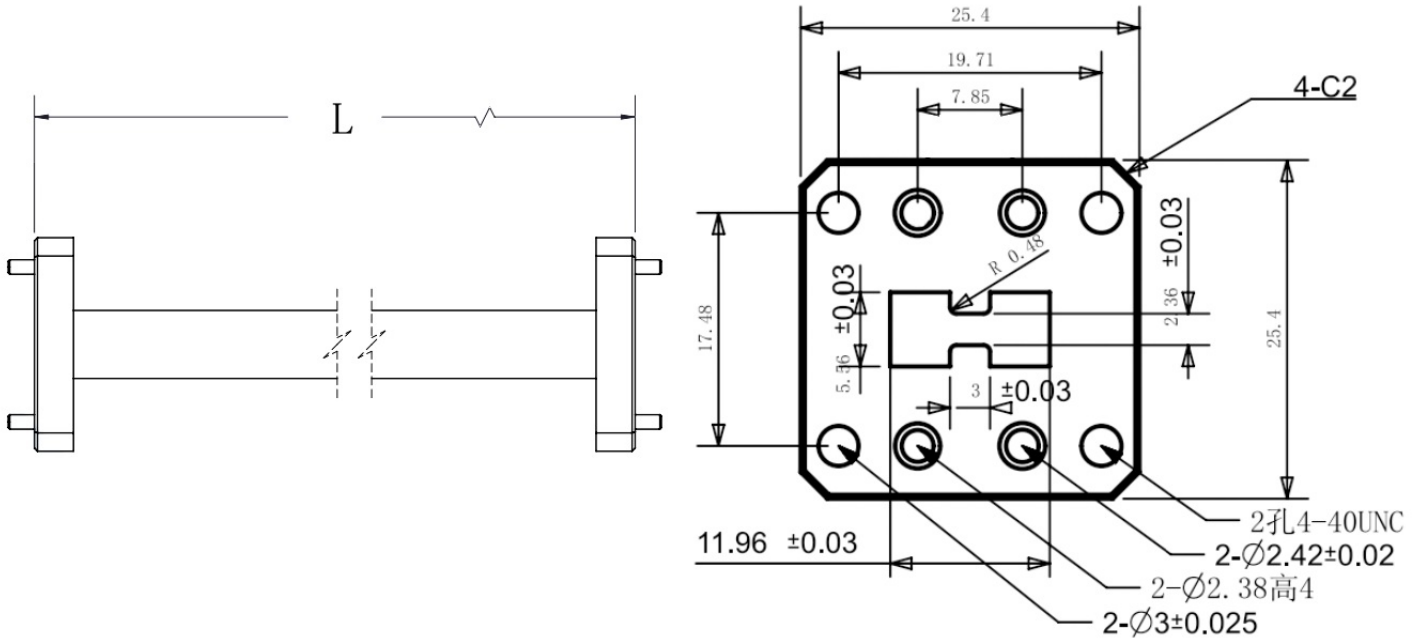

Electrical & Environmental

Frequency Range	11-26.5GHz
Temperature Range	-40°C to 70°C

Product Selection, Customizable			
RFTOP P/N	L(mm)	L2(mm)	IL(dB)

Mechanical & Product Information

Product Number	RWDG110-L
Product Type	Straight Waveguide
Waveguide 1	WRD110, FPWRD110 Rectangular Flange
Waveguide 2	WRD110, FPWRD110 Rectangular Flange
Waveguide Body	Aluminum, grey painted
Center Contact	Aluminum, electric conductive oxidation

Notes

1. Customized services include: length and structure and flange type.
2. The marked loss is the theoretical estimated loss, for reference only, the specific product after processing test shall prevail.
3. Please refer to the second page of the specification of typical electrical performance measured curve.