

## WR340(BJ26) 4 Way Waveguide Power Divider, RWPD340T-4 2420-2480MHz, W, UDR26 Flange, P-Grade

Dimensions(mm) Tolerance $\pm 1\%$

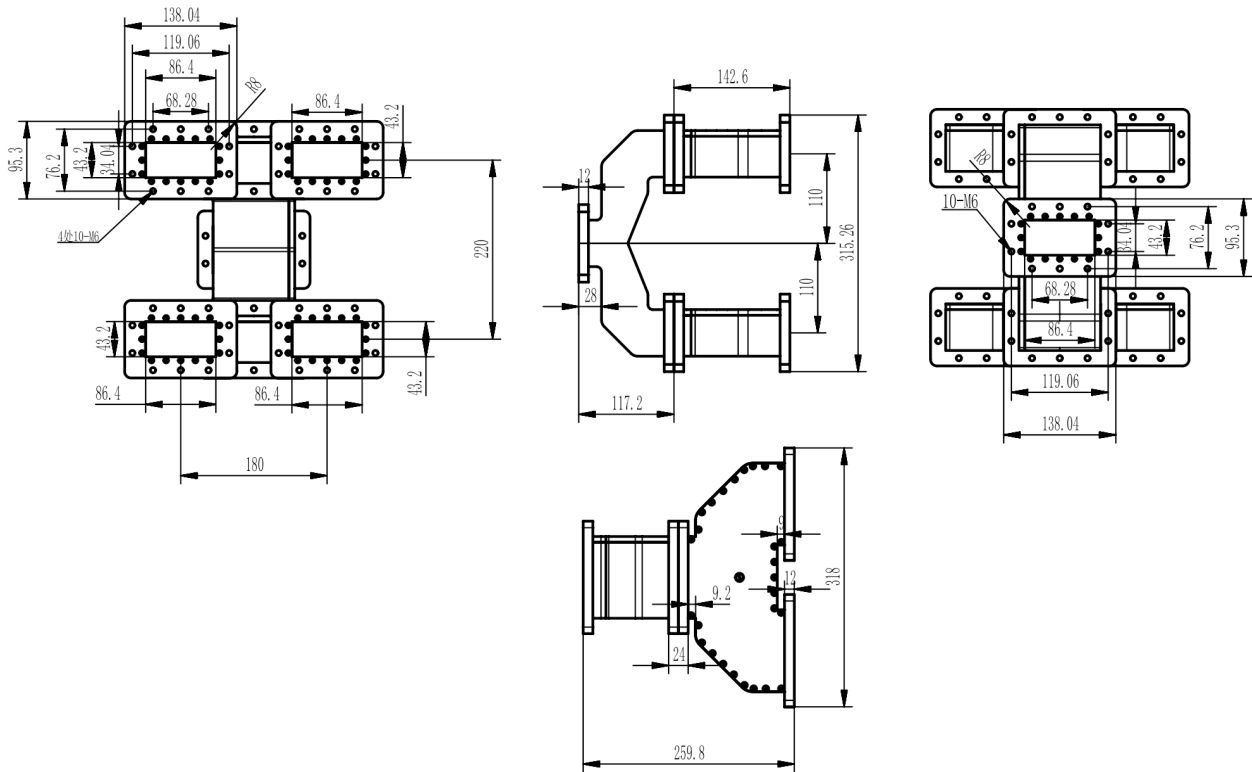

### Electrical & Environmental

Frequency Range	2420-2480MHz	Impedance	50 Ohm
Input Port VSWR	1.2 max	Output Port VSWR	1.2 max
Insertion Loss	0.4dB max		
Operating Temp	-55°C ~ +85°C		

### Mechanical & Product Information

Product Number	RWPD340T-4, P-Grade	Way	4
Waveguide	WR340(BJ26), UDR26 Flange	Waveguide Body	Aluminum, grey painted
Center Contact	Aluminum, electric conductive oxidation		
Housing	Grey paint		
Dimensions	318×259.8×315.26mm	Net Weight	-