

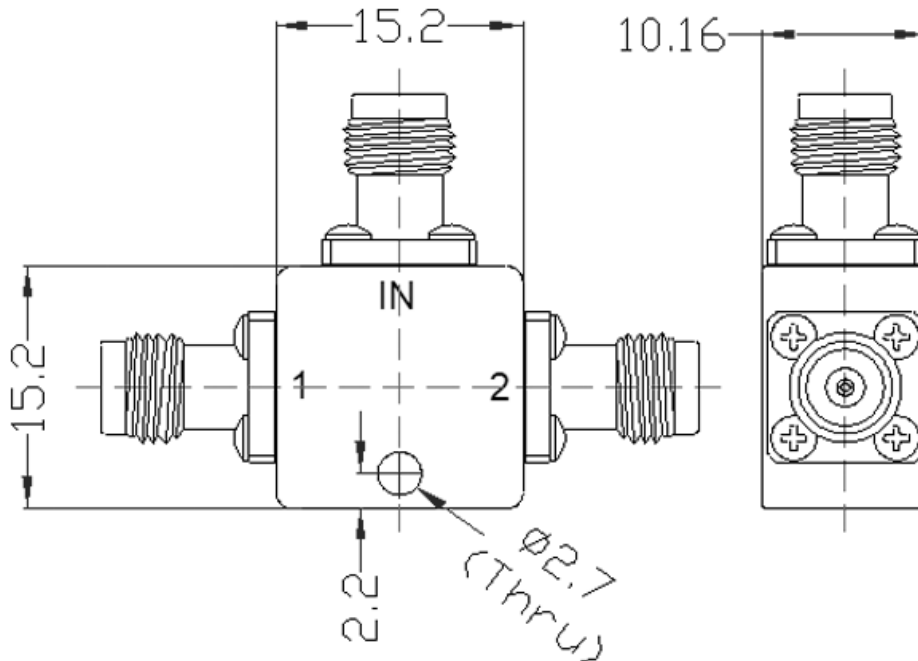

2.4mm 2 Way Resistive Power Divider, RPD50F2-A DC-50GHz, 0.1W, P-Grade

Dimensions(mm) Tolerance $\pm 1\%$



Electrical & Environmental

Frequency Range	DC-50GHz	Impedance	50 Ohm
Input Port VSWR	1.6 max	Output Port VSWR	1.6 max
Insertion Loss	2.8dB max (Does not contain theory loss 6.02dB)		
Amplitude Balance	$\leq \pm 0.8\text{dB}$	Phase Balance	$\leq \pm 8^\circ$
Input Avg Power	0.1 Watts max @25°C		
Operating Temp	-40°C ~ +80°C		

Mechanical & Product Information

Product Number	RPD50F2-A, P-Grade	Way	2
Connector	2.4mm Female	Connector Body	Passivated stainless steel
Center Contact	Gold plated beryllium copper		
Housing	Housing: 6061 Aluminum alloy, Black paint; Cover: LY12 Aluminum alloy		
Dimensions	15.2×15.2×10.16mm	Net Weight	About 20.0g



2.4mm 2 Way Resistive Power Divider, RPD50F2-A DC-50GHz, 0.1W, P-Grade

Typical Test Data

