

SMA Triplexer, RFPT10086S-2692M
Pass Band 880-915MHz, 1760-1830MHz, 2640-2745MHz

Dimensions(mm) Tolerance±1%

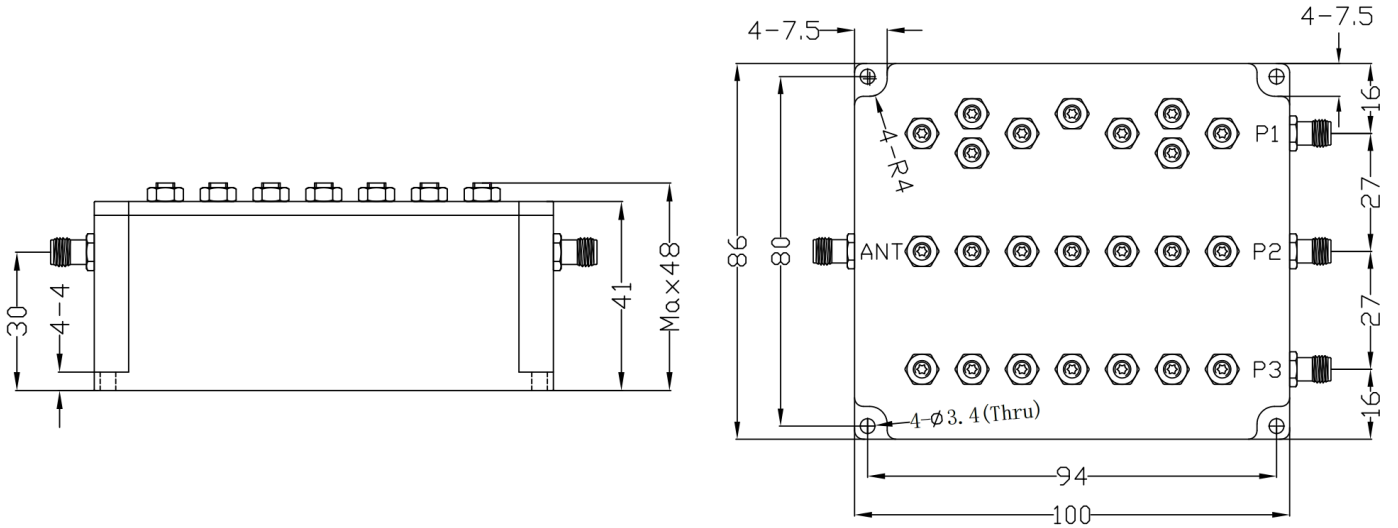

Mechanical & Product Information

Product Number	RFPT10086S-2692M	Product Type	Triplexer
Impedance	50 Ohms	Power Handling	100W @25°C
Connector	SMA Female - SMA Female	Connector Body	Passivated stainless steel
Housing	6061 Aluminum alloy, Black Paint	Operating Temp.	-30 ~ +70°C
Identification	Port 1: ANT , Port 2: P1 , Port 3: P2 , Port 4: P3		
Dimensions	100×86×41mm	Net Weight	About 475.0g

Port Parameter Performance Table

Port/Channel	Pass Band				Stop Band	
	Center Freq.	Pass Band	IL.	Ripple	Reject Freq.	Rejection
P1	897.5MHz	880-915MHz	≤dB	-	1760-2745MHz	≥60dB
P2	1795MHz	1760-1830MHz	≤dB	-	DC-915MHz, 2640-2745MHz	≥60dB
P3	2692.5MHz	2640-2745MHz	≤dB	-	DC-1830MHz	≥60dB

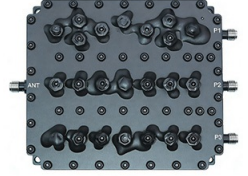

SMA三工器, RFPT10086S-2692M

880-915MHz, 1760-1830MHz, 2640-2745MHz, 耦合度dB, 100W, 不锈钢

典型实测曲线

