

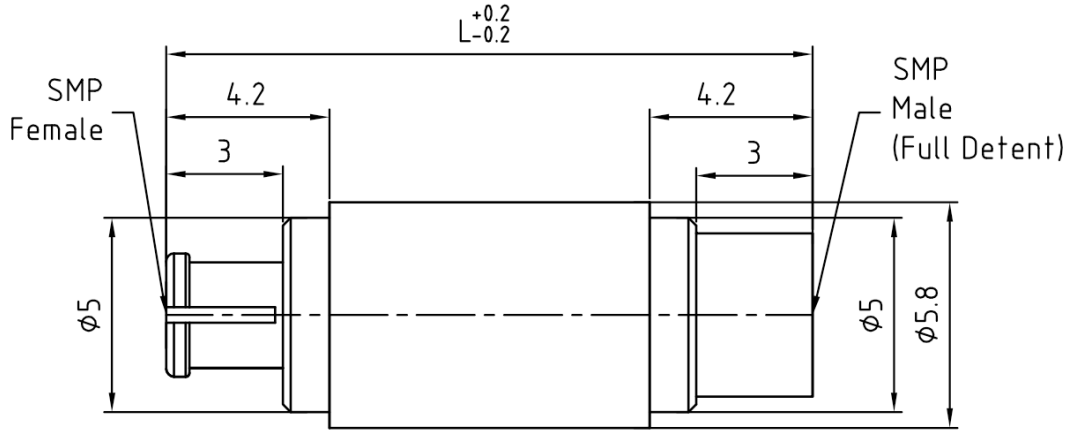

SMP(GPO) Male Full Detent to SMP(GPO) Female Inner DC Block, RBK18P50

9KHz-18GHz, 50V

Dimensions(mm) Tolerance±1%



Electrical & Environmental

Frequency Range	9KHz-18GHz	Impedance	50 Ohm
VSWR	1.35 Max	Insertion Loss	0.6 dB Max
Voltage	50 Volts Max	Input Avg Power	-

Mechanical & Product Information

Product Number	RBK18P50, H-Grade	Connector	SMP(GPO) Male Full Detent to SMP(GPO) Female
Connector Body	Passivated stainless steel, Gold plated brass, Gold plated beryllium copper	Center Contact	Gold plated brass, Gold plated beryllium copper
Net Weight	-	RoHS	Compliant

Typical Test Data

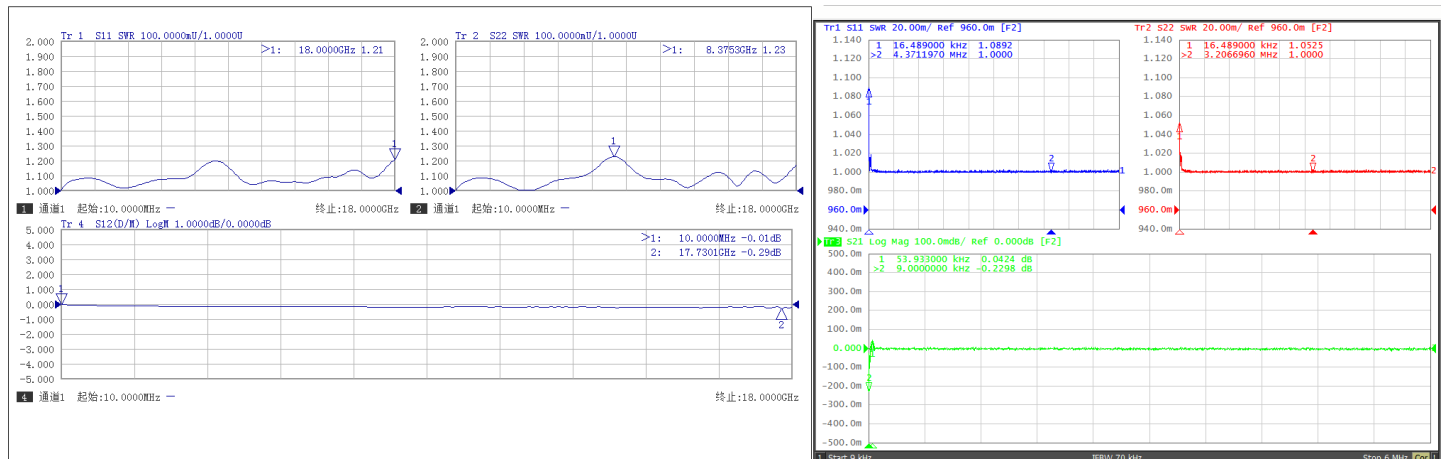



Microwave and Millimeter wave products
supplier

RFTOP® Technology Co., Ltd.
www.rftop.com service@rftop.com 86-755-88840350