

## WR19 Waveguide Dual Directional Coupler, RWDCD19-40 39.2-59.6GHz, Coupling 40dB, FUGP500 Circular Flange

### Dimensions(mm) Tolerance±1%

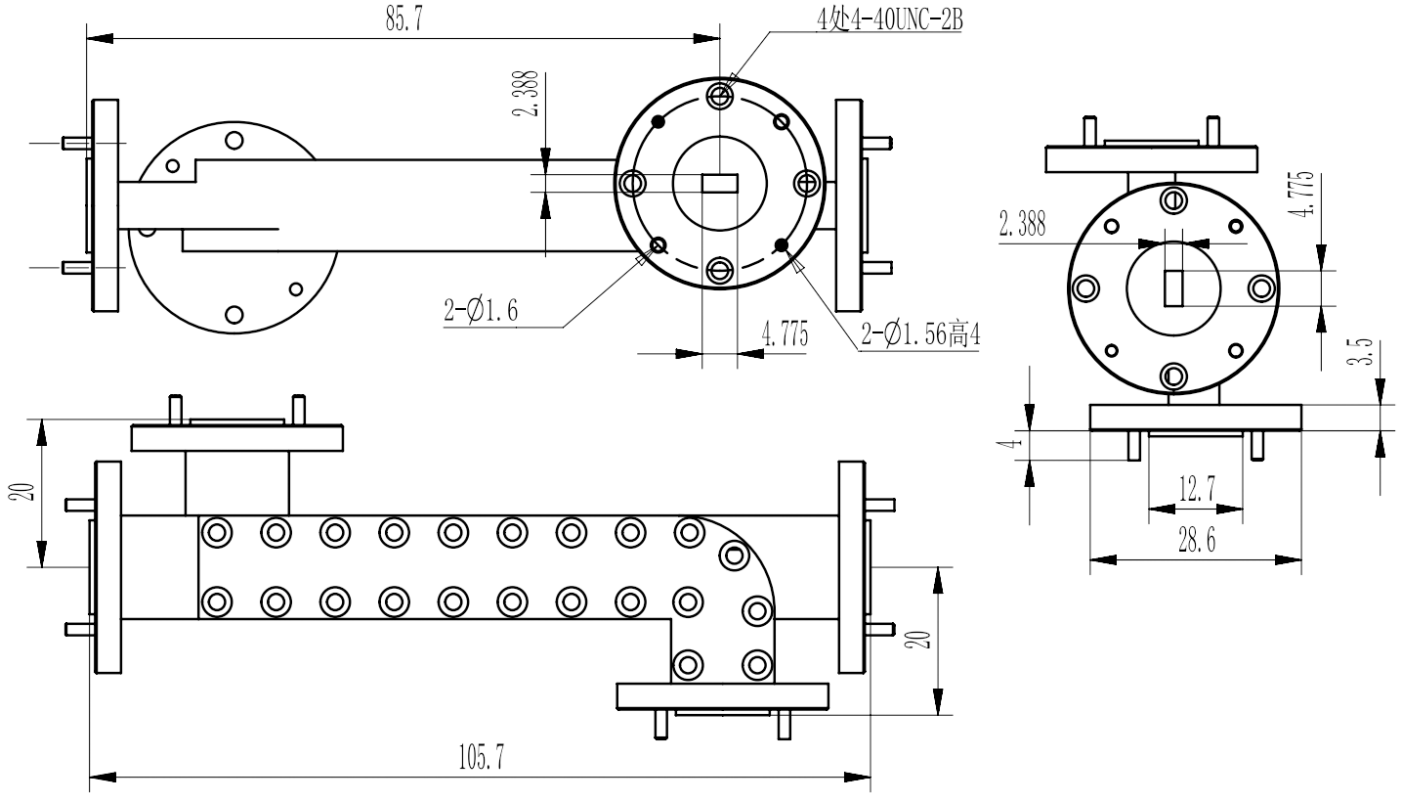

### Electrical & Environmental

Frequency Range	39.2-59.6GHz	Impedance	50 Ohm
VSWR Primary	1.1 Max		
VSWR Secondary	1.15 Max		
Insertion Loss	dB Max		
Directivity	27dB Min		
Nominal Coupling	40±1.0dB		

### Mechanical & Product Information

Product Number	RWDCD19-40, P-Grade	Product Type	Waveguide Dual Directional Coupler
Waveguide	WR19(BJ500), FUGP500 Circular Flange	Waveguide Body	Copper, gold plated
Center Contact	Copper, gold plated		
Housing	Copper, gold plated		
Dimensions	105.7(L)×28.6(φ)mm	Net Weight	-

