

WR90 Directional Waveguide Coupler, RWDC90-40 8.6-10.6GHz, Coupling 40dB, FBP100(UBR) Flange

Dimensions(mm) Tolerance±1%

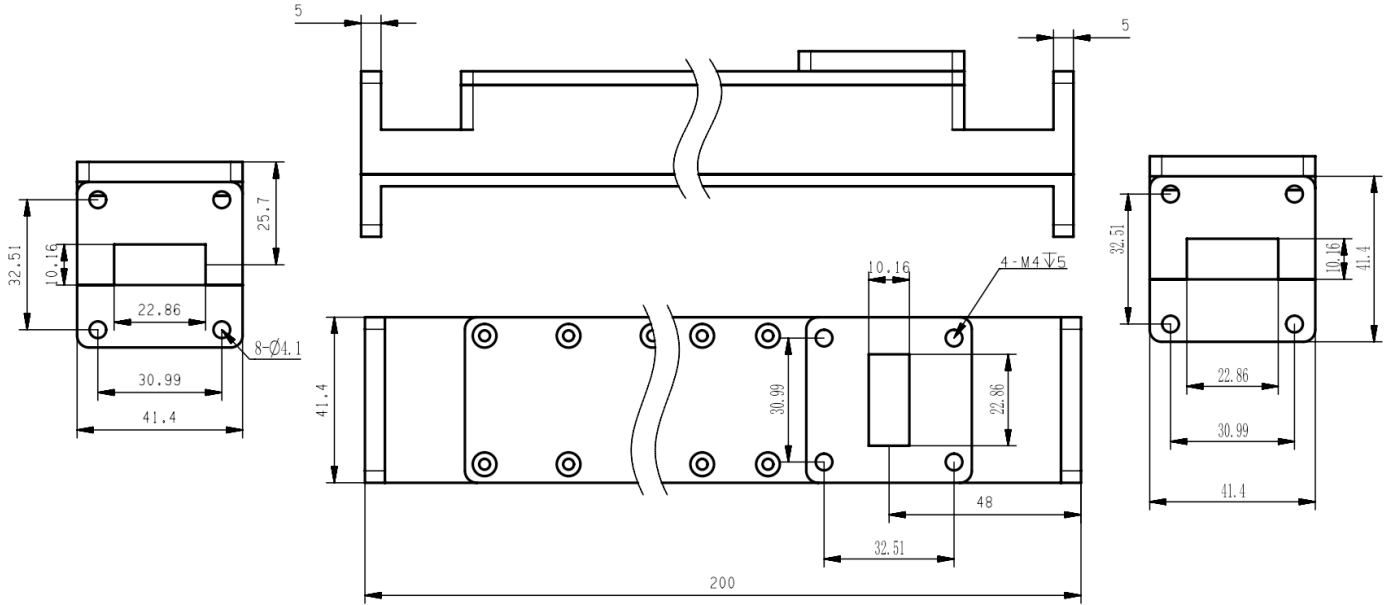

Electrical & Environmental

Frequency Range	8.6-10.6GHz	Impedance	50 Ohm
VSWR Primary	1.15 Max		
VSWR Secondary	1.3 Max		
Insertion Loss	dB Max		
Directivity	30dB Min		
Nominal Coupling	40±1.0dB		
Operating Temp	-40°C~+85°C		

Mechanical & Product Information

Product Number	RWDC90-40, P-Grade, High Directional	Product Type	Waveguide Coupler
Waveguide	WR90(BJ100), FBP100(UBR) Flange	Waveguide Body	Aluminum, grey painted
Center Contact	Aluminum, electric conductive oxidation		
Housing	Grey paint		
Dimensions	200(L)×41.4(W)×41.4(H)mm	Net Weight	-