

WR28 Directional Waveguide Coupler, RWDC28-30 26.5-40GHz, Coupling 30dB, 200W, UBR320 Flange

Dimensions(mm) Tolerance±1%

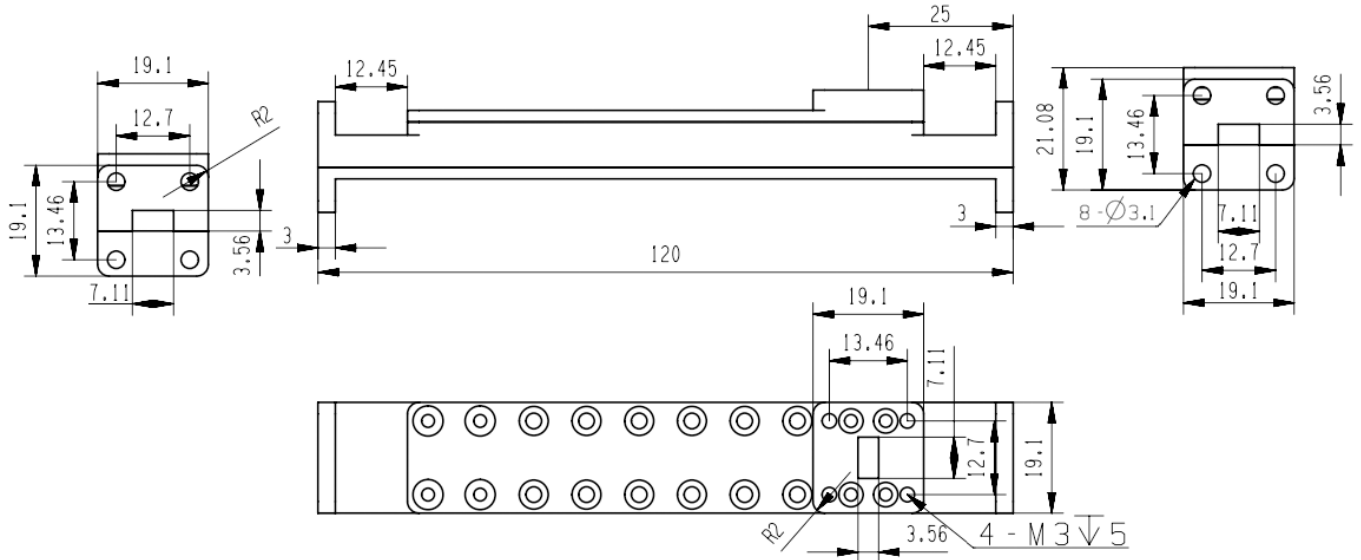

Electrical & Environmental

Frequency Range	26.5-40GHz	Impedance	50 Ohm
VSWR Primary	1.1 Max		
VSWR Secondary	1.3 Max		
Nominal Coupling	30±1.0dB		
Directivity	25dB Min		
Input Avg Power	200 Watts Max @25°C		

Mechanical & Product Information

Product Number	RWDC28-30, P-Grade, High Directional	Product Type	Waveguide Coupler
Waveguide	WR28(BJ320), UBR320 Flange	Waveguide Body	Aluminum, grey painted
Center Contact	Aluminum, electric conductive oxidation		
Housing	Grey paint		
Dimensions	120×19.1×19.1mm	Net Weight	-