

WR28 Waveguide Directional Coupler, RWDC28-20 26.5-40GHz, Coupling 20dB, 200W, FBP320(UBR) Flange

Dimensions(mm) Tolerance±1%

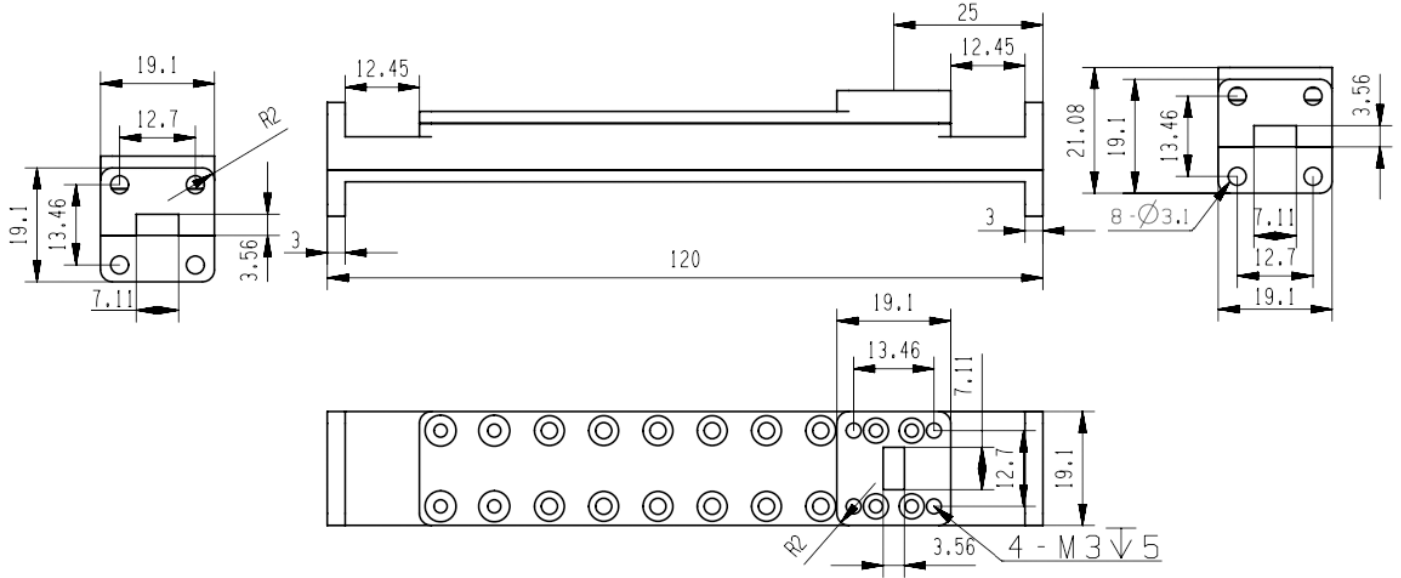

Electrical & Environmental

Frequency Range	26.5-40GHz	Impedance	50 Ohm
VSWR Primary	1.1 Max		
VSWR Secondary	1.3 Max		
Insertion Loss	dB Max		
Directivity	25dB Min		
Nominal Coupling	20±1.0dB		
Input Avg Power	200 Watts max @25°C (Derate linearly to 20 Watt at 100°C)		

Mechanical & Product Information

Product Number	RWDC28-20, P-Grade	Product Type	Waveguide Directional Coupler
Waveguide	WR28(BJ320), FBP320(UBR) Flange	Waveguide Body	Aluminum, grey painted
Center Contact	Aluminum, electric conductive oxidation		
Housing	Grey paint		
Dimensions	120×19.1×19.1mm	Net Weight	-