

2.92mm Degree Bridge, RDCBA2F43K-12 2-43GHz, 10W

Dimensions(mm) Tolerance $\pm 1\%$

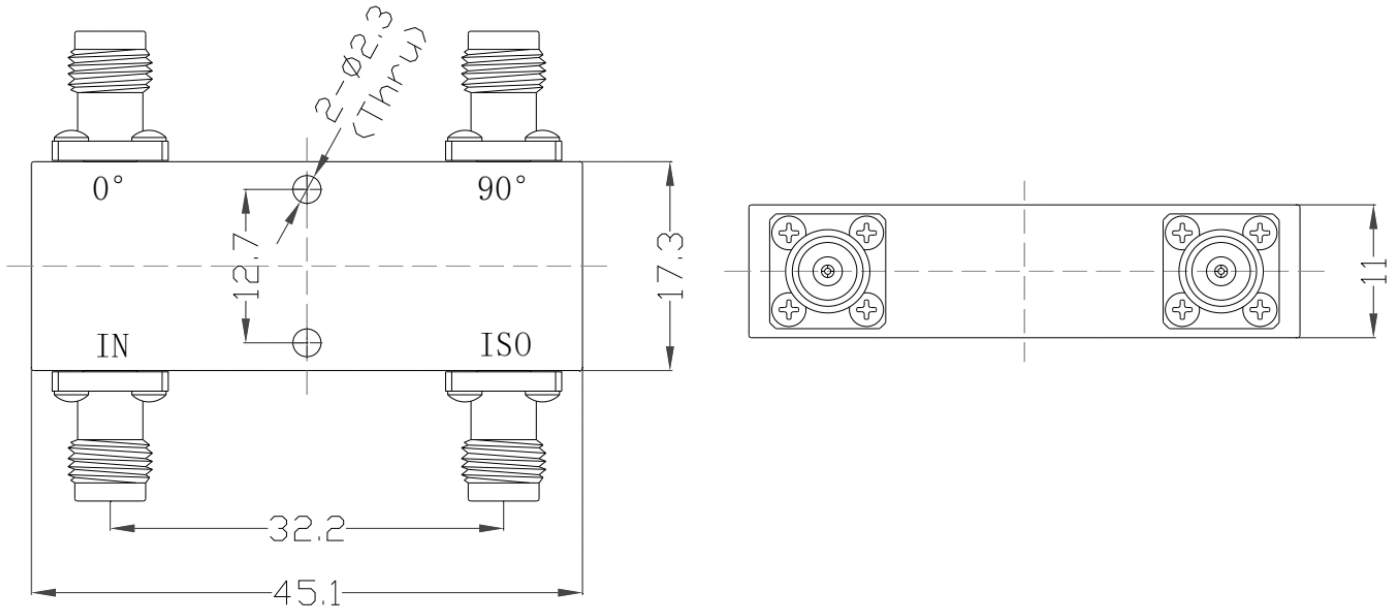

Electrical & Environmental

Frequency Range	2-43GHz	Impedance	50 Ohm
VSWR Primary	1.8 Max		
VSWR Secondary	Max		
Insertion Loss	3.8dB Max		
Phase Balance	$\pm 12^\circ$		
Input Avg Power	10 Watts max @25°C (Derate linearly to 1 Watt at 100°C)		
Operating Temp	-40°C~+80°C		

Mechanical & Product Information

Product Number	RDCBA2F43K-12	Product Type	Degree Bridge
Connector	2.92mm Female	Connector Body	Passivated stainless steel
Center Contact	Gold plated beryllium copper		
Housing	Light blue paint		
Dimensions	45.1×17.3×11mm	Net Weight	About 37.0g