

2.92mm Directional Coupler, RDC1F40K-30 1-40GHz, Coupling 30dB, 20W

Dimensions(mm) Tolerance $\pm 1\%$

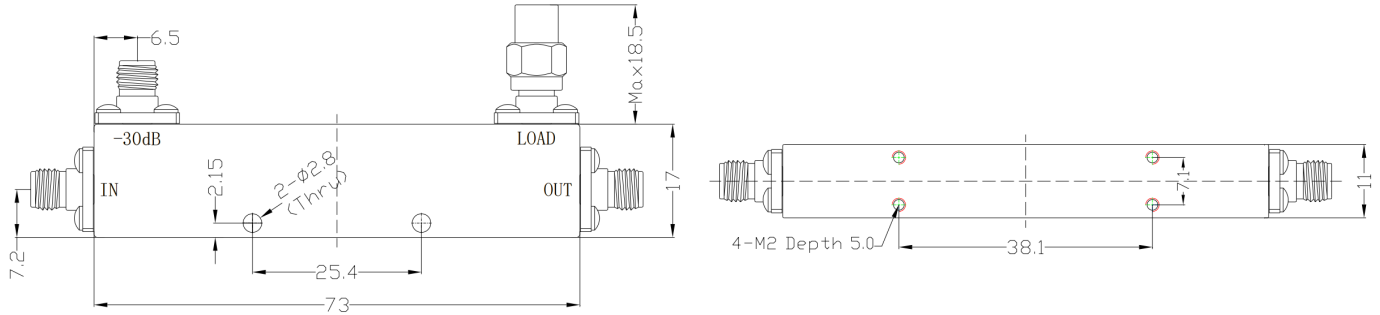

Electrical & Environmental

Frequency Range	1-40GHz	Impedance	50 Ohm
VSWR Primary	1.7 Max		
VSWR Secondary	Max		
Insertion Loss	2dB Max (Excluding Coupling Loss 0.01dB)		
Directivity	10dB Min		
Frequency Sensitivity	± 1.5 dB		
Nominal Coupling	30 ± 1.0 dB		
Input Avg Power	20 Watts max @25°C (Derate linearly to 2 Watt at 100°C) Reflected: 1W Max.		
Operating Temp	-40°C~+85°C		

Mechanical & Product Information

Product Number	RDC1F40K-30	Product Type	Directional Coupler
Connector	2.92mm Female	Connector Body	Passivated stainless steel
Center Contact	Gold plated beryllium copper		
Housing	Light blue paint		
Dimensions	73 \times 17 \times 11mm	Net Weight	About 60.0g