

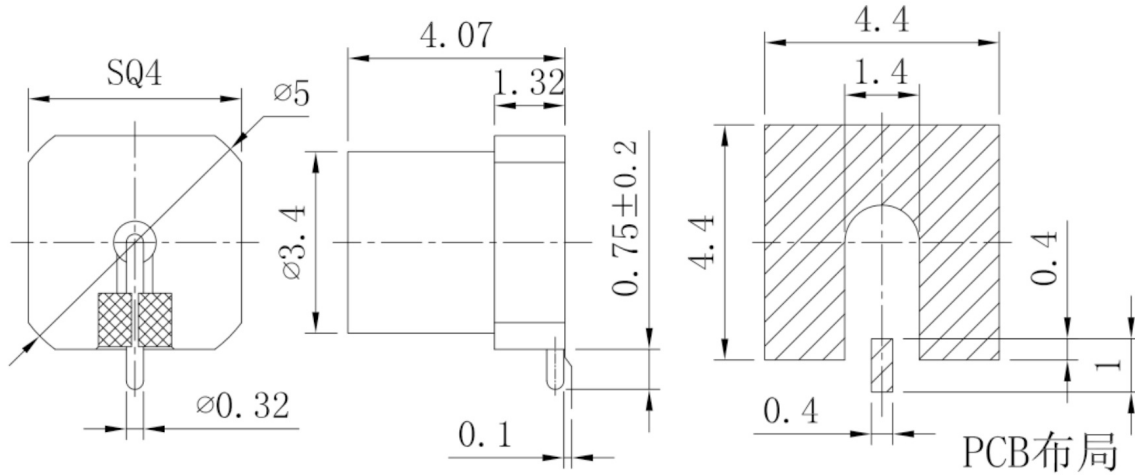

SSMP(GPPO,SMPP) Male Full Detent PCB Connector, RC40SPM-SSM031-GBA

DC-30GHz, Straight, 0.32mm Pin

Dimensions(mm) Tolerance $\pm 1\%$



Electrical & Environmental

Frequency Range	DC-30GHz
Impedance	50 ohm
VSWR	1.6 max
Insulation Resistance	$\geq 5000 \text{ M}\Omega$
Withstand Voltage	500 V
Mating Cycles	> 500 Cycles
Temperature Range	-55°C~+155°C

Mechanical & Product Information

Product Number	RC40SPM-SSM031-GBA
Product Type	SSMP Male Full Detent, PCB Connector
Shape/Mounting	Straight
Attachment Method	Solder
Connector Body	Gold plated brass
Center Contact	Gold plated beryllium copper
Insulator	PEEK
Dimension	4.07(L)mm
Net Weight	About .2g



Microwave and Millimeter wave products
supplier

RFTOP® Technology Co., Ltd.
www.rftop.com service@rftop.com 86-755-88840350