

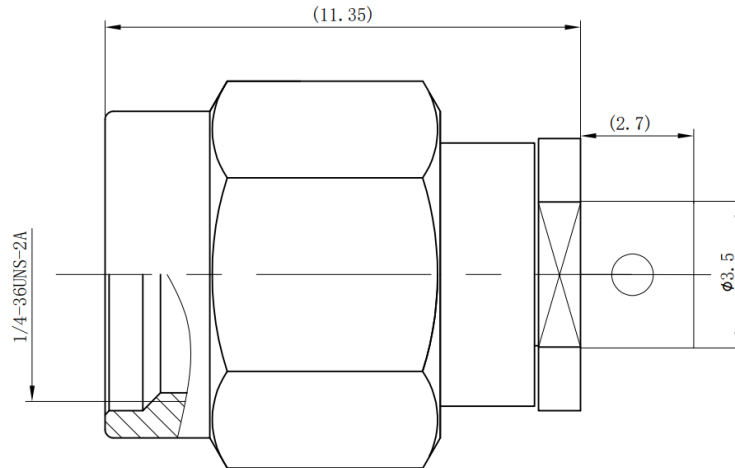

2.92mm Male Cable Connector, RC40M-B350 DC-40GHz, Straight

Dimensions(mm) Tolerance $\pm 1\%$



Electrical & Environmental

| | |
|------------------------------|------------------------------------|
| Frequency Range | DC-40GHz |
| Impedance | 50 ohm |
| VSWR | 1.25 max |
| Contact Resistance | \leq In:3.0/Out:2.0 m Ω |
| Insulation Resistance | \geq 5000 M Ω |
| Withstand Voltage | 500 V |
| Mating Cycles | > 500 Cycles |
| Temperature Range | -55 $^{\circ}$ C~+165 $^{\circ}$ C |

Mechanical & Product Information

| | |
|--------------------------|------------------------------|
| Product Number | RC40M-B350 |
| Product Type | 2.92mm Male, Cable Connector |
| Shape/Mounting | Straight |
| Attachment Method | Solder |
| Attachment for | - |
| Connector Body | Passivated stainless steel |
| Center Contact | Gold plated beryllium copper |
| Insulator | PEEK |
| Dimension | 11.35(L)mm |