

## SMA Male Cable Connector, RC27SMW-BG142E DC-26.5GHz, Right Angle, Attachment for RG142 Cable

### Dimensions(mm) Tolerance $\pm 1\%$

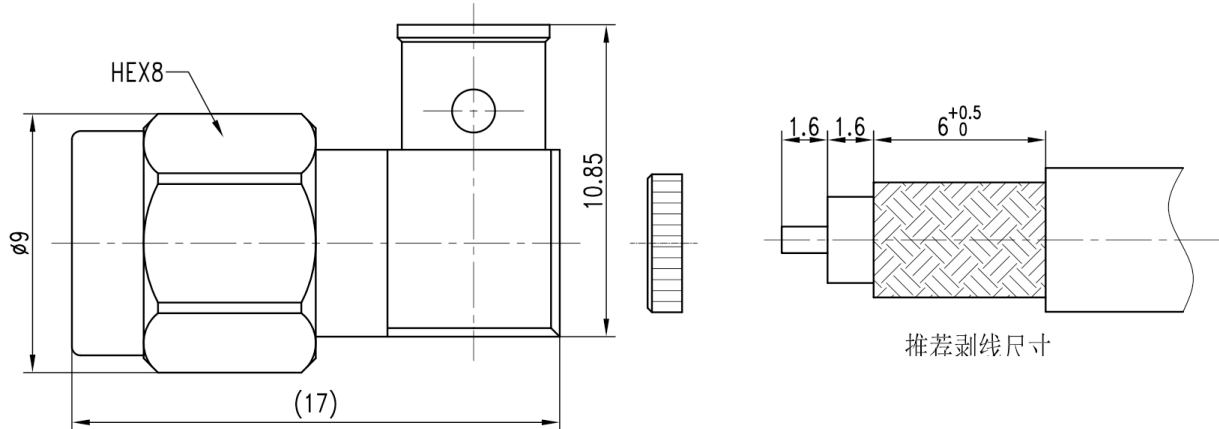

### Electrical & Environmental

<b>Frequency Range</b>	DC-26.5GHz	<b>Impedance</b>	50 ohm
<b>VSWR</b>	-	<b>Withstand Voltage</b>	1000 V
<b>Mating Cycles</b>	> 500 Cycles	<b>Temperature Range</b>	-55°C ~ +165°C

### Mechanical & Product Information

<b>Product Number</b>	RC27SMW-BG142E, P-Grade	<b>Connector</b>	SMA Male
<b>Shape/Mounting</b>	Right Angle	<b>Attachment Method</b>	Solder
<b>Attachment for</b>	RG142 Series Cable		
<b>Connector Body</b>	Passivated stainless steel 316F	<b>Insulator</b>	PTFE
<b>Center Contact</b>	Gold plated beryllium copper		
<b>Dimension</b>	17(L) $\times$ 10.85(W)mm	<b>Net Weight</b>	-