

SMA Female PCB Connector, RC27SFW-STH127
DC-26.5GHz, Right Angle, 5.08mm Hole Spacing, 1.27mm Pin

Dimensions(mm) Tolerance±1%

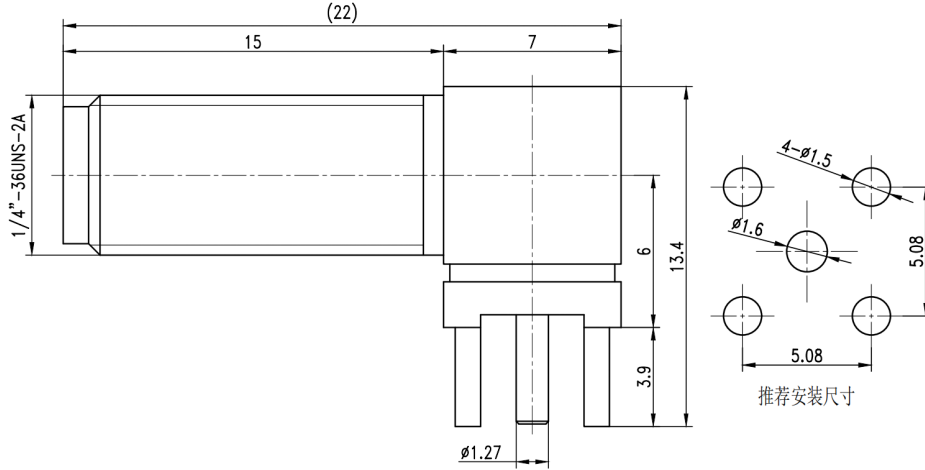

Electrical & Environmental

Frequency Range	DC-26.5GHz
Impedance	50 ohm
Contact Resistance	≤ In:3.0/Out:2.0 mΩ
Insulation Resistance	≥ 5000 MΩ
Withstand Voltage	1000 V
Mating Cycles	> 500 Cycles
Temperature Range	-55°C~+165°C

Mechanical & Product Information

Product Number	RC27SFW-STH127, H-Grade
Product Type	SMA Female, PCB Connector
Shape/Mounting	Right Angle
Attachment Method	Solder
Center Contact	Gold plated beryllium copper
Dimension	22(L)*13.4(W)mm