

SMA Female Bulkhead Thread-in Connector, RC18SFW-PFD13-GBA
DC-18GHz, Right Angle, 4 hole flange, 8.6mm Hole Spacing, 1.3mm Pin

Dimensions(mm) Tolerance $\pm 1\%$

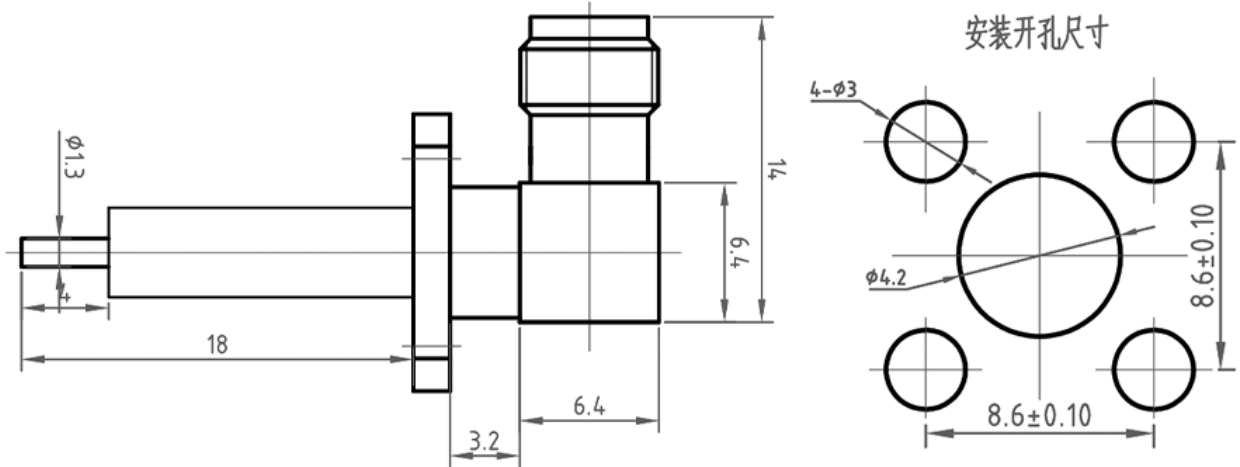

Electrical & Environmental

Frequency Range	DC-18GHz
Impedance	50 ohm
VSWR	1.25 max
Insulation Resistance	$\geq 5000 \text{ M}\Omega$
Withstand Voltage	500 V
Mating Cycles	> 500 Cycles
Temperature Range	-55°C ~ +155°C

Mechanical & Product Information

Product Number	RC18SFW-PFD13-GBA
Product Type	SMA Female, Bulkhead Thread-in Connector
Shape/Mounting	Right Angle, 4 hole flange
Attachment Method	Solder
Connector Body	Gold plated brass
Center Contact	Gold plated beryllium copper
Insulator	PTFE
Dimension	14(L)*29(W)mm