

SMA Female Field Replaceable Connector, RC18SF-UFD127

DC-18GHz, Straight, 4 hole flange, 8.6mm Hole Spacing, 1.27mm Pin

Dimensions(mm) Tolerance $\pm 1\%$

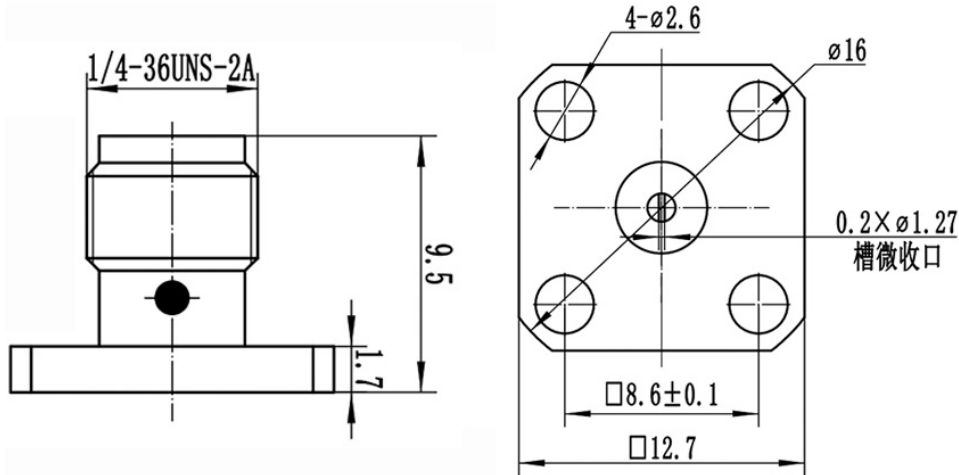

Electrical & Environmental

Frequency Range	DC-18GHz
Impedance	50 ohm
VSWR	1.2 max
Contact Resistance	\leq In:3.0/Out:2.0 m Ω
Insulation Resistance	\geq 5000 M Ω
Withstand Voltage	750 V
Mating Cycles	> 500 Cycles
Temperature Range	-55 $^{\circ}$ C~+165 $^{\circ}$ C

Mechanical & Product Information

Product Number	RC18SF-UFD127
Product Type	SMA Female, Field Replaceable Connector
Shape/Mounting	Straight, 4 hole flange
Attachment Method	Field Replaceable
Connector Body	Passivated stainless steel
Center Contact	Gold plated beryllium copper
Insulator	PTFE
Dimension	9.5(L)mm