

## SMA Female Bulkhead Flange Connector, RC18SF-MF2D046

### DC-18GHz, Straight, 2 hole flange, 8.6mm Hole Spacing, 0.46mm Pin

#### Dimensions(mm) Tolerance $\pm 1\%$

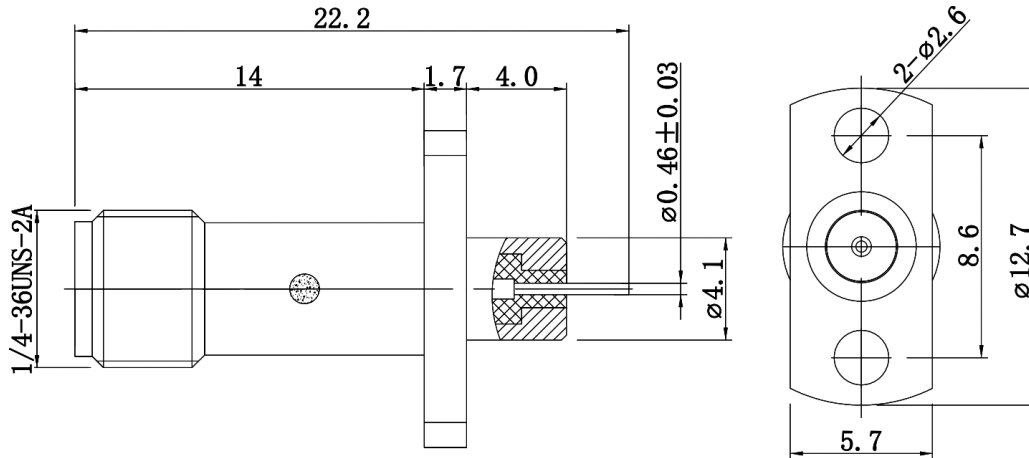

#### Electrical & Environmental

Frequency Range	DC-18GHz
Impedance	50 ohm
VSWR	1.2 max
Contact Resistance	$\leq$ In:3.0/Out:2.0 m $\Omega$
Insulation Resistance	$\geq$ 5000 M $\Omega$
Withstand Voltage	1000 V
Mating Cycles	> 500 Cycles
Temperature Range	-45°C~+125°C

#### Mechanical & Product Information

Product Number	RC18SF-MF2D046, E-Grade
Product Type	SMA Female, Bulkhead Flange Connector
Shape/Mounting	Straight, 2 hole flange
Attachment Method	Solder
Connector Body	Passivated stainless steel
Center Contact	Gold plated beryllium copper
Insulator	PTFE
Dimension	22.2(L)mm