

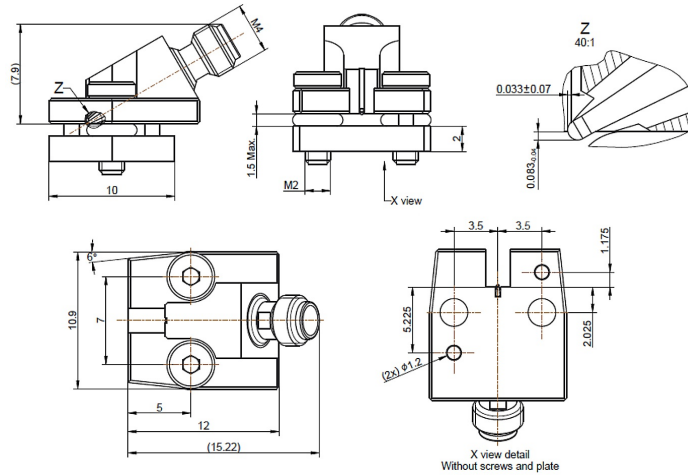

1.0mm Female PCB Connector, RC110F-EL02
DC-110GHz, 30° Angle, 2 hole flange, 7mm Hole Spacing, 0.2mm Pin

Dimensions(mm) Tolerance±1%



Electrical & Environmental

Frequency Range	DC-110GHz
Impedance	50 ohm
VSWR	1.9 max
Temperature Range	-45°C~+85°C

Mechanical & Product Information

Product Number	RC110F-EL02
Product Type	1.0mm Female, PCB Connector
Shape/Mounting	30° Angle, 2 hole flange
Attachment Method	Clamp
Connector Body	Passivated stainless steel/Gold plated brass
Center Contact	Gold plated beryllium copper
Insulator	PEI/equivalen
Dimension	15.22(L)*10.9(W)mm