

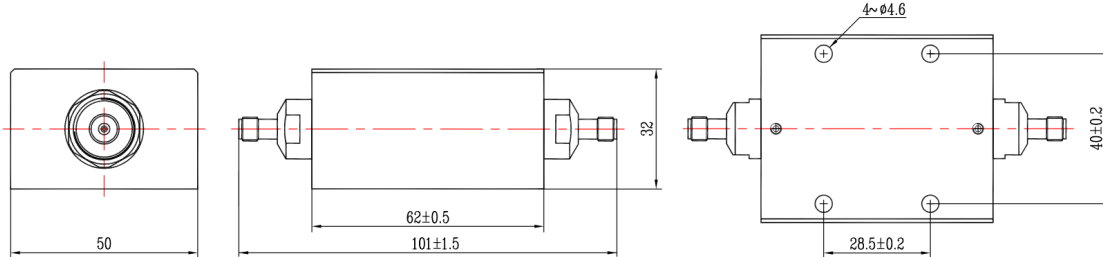

SMA Coaxial Fixed Attenuator, R4S50UC-XX DC-4GHz, 50W, 1-50dB, Unidirectional, Rectangular

Dimensions(mm) Tolerance±1%



Electrical & Environmental

Frequency Range	DC-4GHz , 50Ohms
VSWR	1.2 Max
Input Avg Power	50W @25°C
Peak Power	500W (5μsec pulse width, 5% duty cycle)
Temp Coefficient	<0.0004 dB/dB/°C
Direction	Unidirectional, SMA female input to SMA female output
Attenuation	1-50dB
Operating Temp	-55°C~+100°C

Product Selection, Customizable		
RFTOP P/N	ATTEN	Accuracy
R4S50UC-3	3 dB	±0.4 dB
R4S50UC-6	6 dB	±0.4 dB
R4S50UC-10	10 dB	±0.4 dB
R4S50UC-20	20 dB	±0.5 dB
R4S50UC-30	30 dB	±0.7 dB
R4S50UC-40	40 dB	±0.7 dB
R4S50UC-50	50 dB	±0.7 dB

Mechanical & Product Information

Product Number	R4S50UC-XX
Product Type	Coaxial Fixed Attenuator, P-Grade, Built-IN
Connector	SMA female, SMA female
Connector Body	Passivated stainless steel
Center Contact	Gold plated beryllium copper
Heat Sink	Black anodized aluminum
Net Weight	About 290.0g

Notes: Pay attention to input/output. To ensure longevity and performance, do not use at full power for a long time. Peak power, pulse width, and duty cycle need to meet the requirements. Input high power, require heat dissipation, maintain temperature within 80°C. Reference Curve, derate linearly to 5W at 100°C.

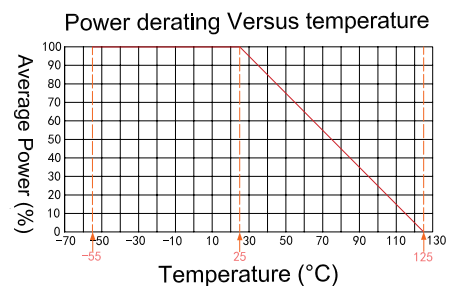

1. Customized connectors, dimensions, directionality, PIM, dB values.
2. Refer to the RFTOP attenuator selection and usage guide.



SMA Coaxial Fixed Attenuator, R4S50UC-XX DC-4GHz, 50W, 1-50dB, Unidirectional, Rectangular

Typical Test Data

