

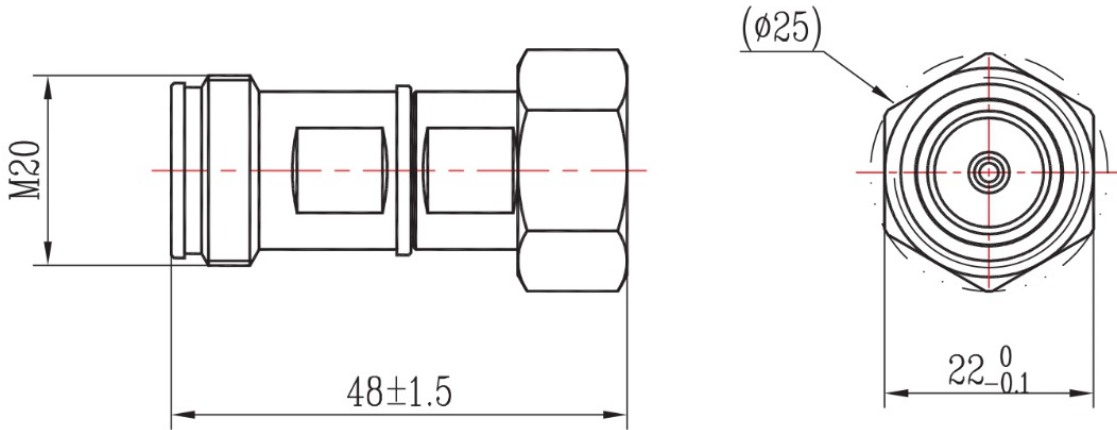

### 4.3-10 Coaxial Fixed Attenuator, R3P2-XX DC-3GHz, 2W, 1-30dB, Bidirectional, Round

#### Dimensions(mm) Tolerance±1%



#### Electrical & Environmental

<b>Frequency Range</b>	DC-3GHz , 50Ohms
<b>VSWR</b>	1.2 Max
<b>Input Avg Power</b>	2W @25°C
<b>Peak Power</b>	200W (5μsec pulse width, 0.5% duty cycle)
<b>Temp Coefficient</b>	<0.0004 dB/dB/°C
<b>Direction</b>	Bidirectional, 4.3-10 male to 4.3-10 female
<b>Attenuation</b>	1-30dB
<b>Operating Temp</b>	-55°C~+125°C

Product Selection, Customizable		
RFTOP P/N	ATTEN	Accuracy
R3P2-3	3 dB	±0.3 dB
R3P2-6	6 dB	±0.3 dB
R3P2-10	10 dB	±0.5 dB
R3P2-20	20 dB	±0.6 dB
R3P2-30	30 dB	±0.8 dB

Notes: Pay attention to input/output. To ensure longevity and performance, do not use at full power for a long time. Peak power, pulse width, and duty cycle need to meet the requirements. Input high power, require heat dissipation, maintain temperature within 80°C. Reference Curve, derate linearly to 0.2W at 100°C.

#### Mechanical & Product Information

<b>Product Number</b>	R3P2-XX
<b>Product Type</b>	Coaxial Fixed Attenuator, P-Grade
<b>Connector</b>	4.3-10 male, 4.3-10 female
<b>Connector Body</b>	Ternary alloy plated brass
<b>Center Contact</b>	Gold plated brass, Gold plated beryllium copper
<b>Heat Sink</b>	N/A
<b>Net Weight</b>	About 60.0g

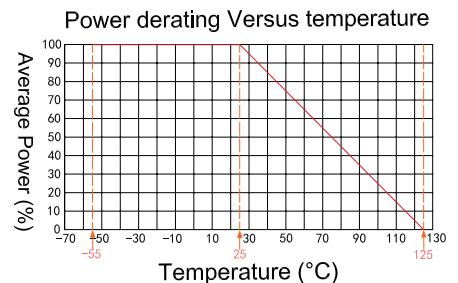

1. Customized connectors, dimensions, directionality, PIM, dB values.
2. Refer to the RFTOP attenuator selection and usage guide.