

## SMA Coaxial Fixed Attenuator, R27S30UH-XX DC-26.5GHz, 30W, 10-40dB, Unidirectional, Round

### Dimensions(mm) Tolerance±1%

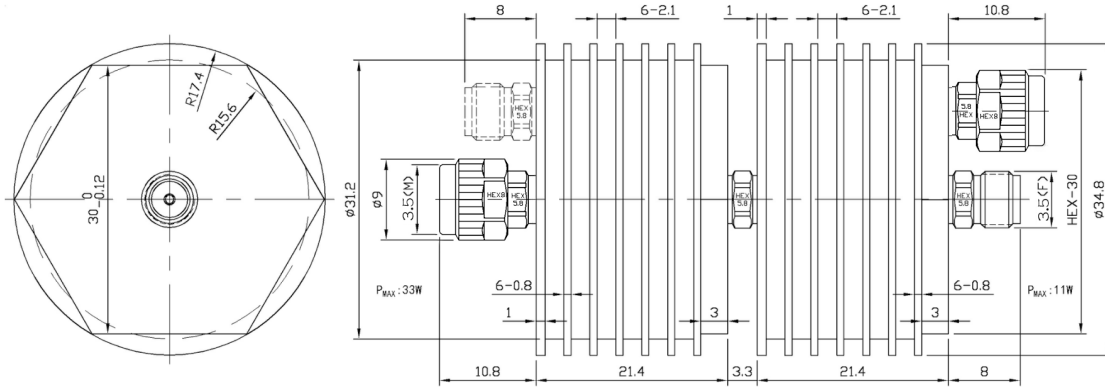

### Electrical & Environmental

<b>Frequency Range</b>	DC-26.5GHz , 50Ohms
<b>VSWR</b>	1.23 Max
<b>Input Avg Power</b>	30W @25°C
<b>Peak Power</b>	200W (5μsec pulse width, 6% duty cycle)
<b>Temp Coefficient</b>	<0.0004 dB/dB/°C
<b>Direction</b>	Unidirectional, SMA male input to SMA female output
<b>Attenuation</b>	10-40dB
<b>Operating Temp</b>	-55°C~+100°C

### Product Selection, Customizable

RFTOP P/N	ATTEN	Accuracy
R27S30UH-10	10 dB	±1.8 dB
R27S30UH-20	20 dB	±1.0 dB
R27S30UH-30	30 dB	±1.0 dB
R27S30UH-40	40 dB	±1.0 dB

**Notes:** Pay attention to input/output. To ensure longevity and performance, do not use at full power for a long time. Peak power, pulse width, and duty cycle need to meet the requirements. Input high power, require heat dissipation, maintain temperature within 80°C. Reference Curve, derate linearly to 3W at 100°C.

### Mechanical & Product Information

<b>Product Number</b>	R27S30UH-XX
<b>Product Type</b>	Coaxial Fixed Attenuator, JP-Grade
<b>Connector</b>	SMA male, SMA female
<b>Connector Body</b>	Passivated stainless steel
<b>Center Contact</b>	1.27um Gold plated beryllium copper
<b>Heat Sink</b>	Black anodized aluminum
<b>Net Weight</b>	About 95.0g

Power derating Versus temperature

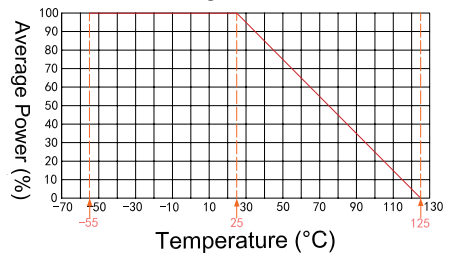

1. Customized connectors, dimensions, directionality, PIM, dB values.

2. Refer to the RFTOP attenuator selection and usage guide.