

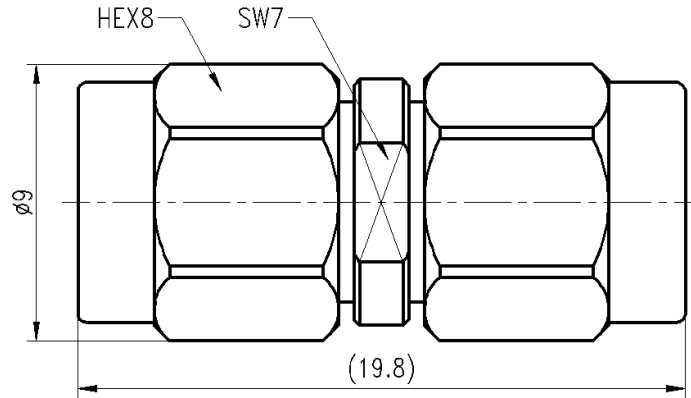

## RP-SMA Male to SMA Male, Adapter, RPA18S02-GBA-2L DC-18GHz, Straight

### Dimensions(mm) Tolerance $\pm 1\%$



### Electrical & Environmental

Frequency Range	DC-18GHz	Impedance	50 ohm
VSWR	1.15 max	Operating Temp	-40°C to +155°C
Insertion Loss	0.20dB max		

### Mechanical & Product Information

Product Number	RPA18S02-GBA-2L, H-Grade, Reverse Polarity	Connector	RP-SMA Male to SMA Male
Connector Body	Gold plated brass	Shape/Mounting	Straight, None
Center Contact	Gold plated beryllium copper	Insulator	PTFE

### Typical Test Data

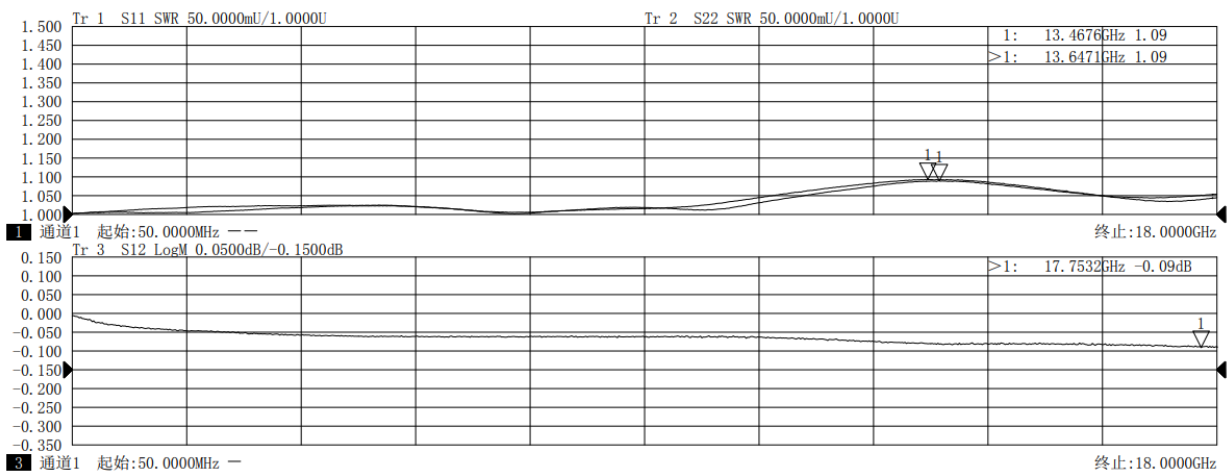

通道	扫描类型	起始频率	终止频率	扫描点数	中频带宽(Hz)	扫描时间(s)	端口1, 2功率(dBm)
通道1	线性扫描	0.050000000GHz	18.000000000GHz	801	1000	0.757065	-5.0, -5.0