

SMA Male 50Ω to BNC Female 75Ω, RF Matching Pads, RAMP04S01 DC-4GHz, Straight

Dimensions(mm) Tolerance±1%

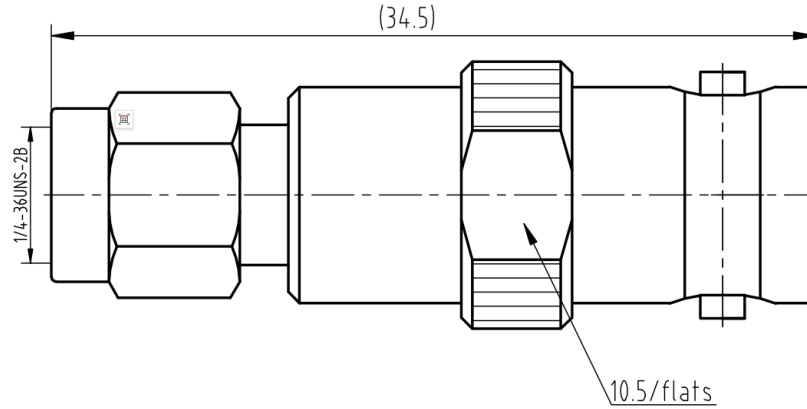

Electrical & Environmental

Frequency Range	DC-4GHz	Impedance	50Ω/75Ω
VSWR	1.25 max	Operating Temp	-65°C to +165°C

Mechanical & Product Information

Product Number	RAMP04S01, E-Grade	Connector	SMA Male 50Ω to BNC Female 75Ω
Connector Body	Nickel plated brass	Shape/Mounting	Straight, None
Center Contact	Gold plated beryllium copper	Insulator	PTFE

