

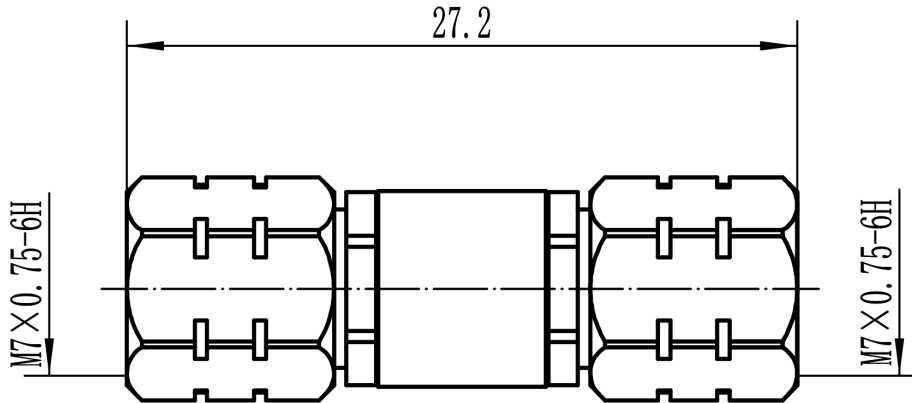

## 1.85mm Male to 1.85mm Male, Adapter, RA6702 DC-67GHz, Straight

Dimensions(mm) Tolerance $\pm 1\%$



### Electrical & Environmental

Frequency Range	DC-67GHz	Impedance	50 ohm
VSWR	1.3 max	Operating Temp	-55°C to +165°C
Insertion Loss	0.55dB max , Typ 0.45dB		

### Mechanical & Product Information

Product Number	RA6702, H-Grade	Connector	1.85mm Male to 1.85mm Male
Connector Body	Passivated stainless steel	Shape/Mounting	Straight, None
Center Contact	Gold plated beryllium copper	Insulator	PEI

### Typical Test Data

